

KSA019

REV.	DESCRIPTION	DATE	ENG	ECO #	APPR
1	CREATE DRAWING	29MAR05	MB		
2	ADD SAFETY TEATHER, CHANGED LATCH PN I PL	4AUG05	M BELL		

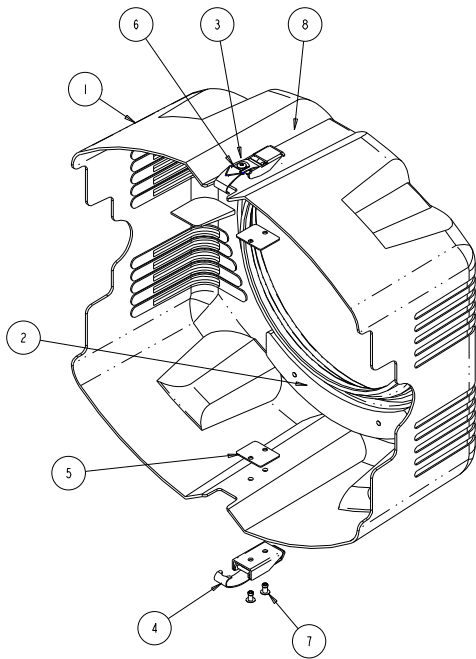

NOTES:
1. PARTS TO BE FIRMLY SEATED PRIOR TO RIVETING OPERATION

ANCILLARY DRAWING

8	4	SCREW8-32PFU380309141	.	SCREW, 8-32 PHIL FLAT UC 3/8 BZ PATCH	
7	5	RIVETS4A0B 90701028	.	RIVET, 5/32" .126-.187 DOMED OPEN, BLACK	
6	1	SP179 90701013	I	RING, D EM, IB, TS, AF	
5	2	KS128 99080270	-	PLATE, BEZEL, BACKUP, S-CMD	
4	1	LATCH-OCL 90410074	A	LATCH, DRAW BLACK TC	
3	1	WP171 85000046	B	LATCH, W/ HOLE STC	
2	2	KS129 80071890	-	COUNTERWEIGHT, HEAD, S-CMD	
1	1	KS204 99350085	A	BEZEL, FRONT HEAD S-CMD	
ITEM NO.	QTY.	FILENAME	PART NO.	REV	DESCRIPTION
BILL OF MATERIALS					

UNLESS OTHERWISE SPECIFIED	RELEASE DATE:	CE:	High End	2105 GRACY FARMS LANE AUSTIN, TEXAS 78758 (512) 836-2242 FAX (512) 832-4128 http://www.highend.com	LR LIGHTWAVE RESEARCH
DIMENSIONAL TOLERANCES: 0 PLACE DECIMAL = ±0.38 1 PLACE DECIMAL = ±0.25 2 PLACE DECIMALS = ±0.13 ANGLES = ±0.5°	ENG:	QA:	ME:	DRW: LARRY R	
FOR PAINTED PARTS REFER TO ENG. SPEC. MANUAL WI-0592	DESCRIPTION: COVER ASSY, HEAD, FRONT S-CMD	MATERIAL: CHARTED	FINISH: NA	INTERPRET DIMENSIONS PER ASME Y14.5M-1994 THIRD ANGLE PROJECTION DIMENSIONS ARE IN MILLIMETERS	SI METRIC A1
MIN. DRAFT	MIN. RADI	THICKNESS	VOLUME	PART NO. NA	DRAWING NO. KSA019
DO NOT SCALE	SCALE: 0.500	SHEET: 1 OF 1	REV. 2		

PROPRIETARY NOTICE:
THIS DOCUMENT CONTAINS CONFIDENTIAL AND PROPRIETARY INFORMATION OF HIGH END SYSTEMS INC., (ALSO DBA LIGHTWAVE RESEARCH) AND IS GIVEN TO THE RECEIVER IN CONFIDENCE. THE RECEIVER ACCEPTS AND AGREES THAT, EXCEPT AS AUTHORIZED BY HIGH END SYSTEMS, THE RECEIVER WILL NOT PERMIT THE USE OF THE DOCUMENT OR ANY COPY THEREOF ON THE INFORMATION THEREIN. WILL NOT COPY OR PERMIT COPYING THE DOCUMENT WILL NOT DISCLOSE TO OTHERS EITHER THE DOCUMENT OR THE INFORMATION THEREIN, AND WILL UPON COMPLETION OF THE NEED TO RETAIN THE DOCUMENT, OR UPON DEMAND, RETURN THE DOCUMENT WITHOUT RETAINING ANY OF THE INFORMATION CONTAINED THEREIN IN ANY FORM WHATSOEVER.