

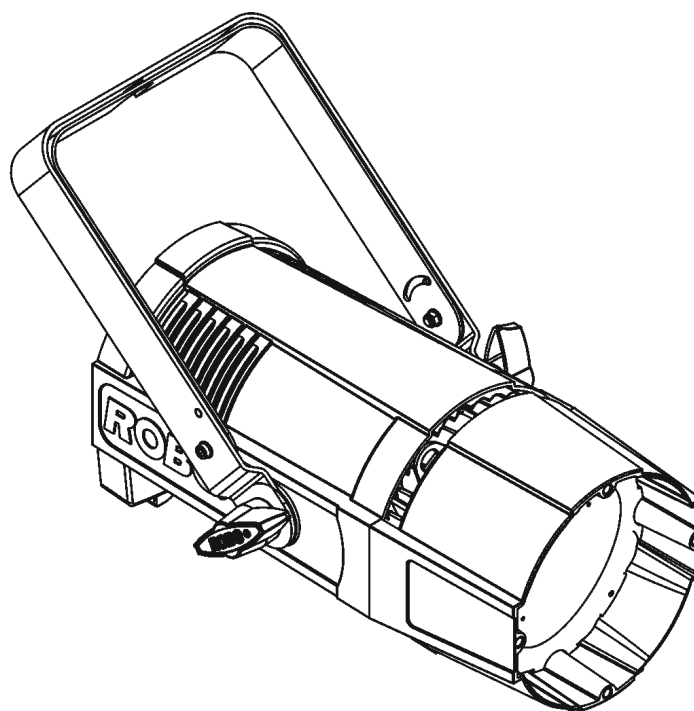

# Robin ParFect S1



**USER MANUAL**

*Version 1.4*

# Robin ParFect S1

## Table of contents

<b>1. Safety instructions .....</b>	<b>3</b>
<b>2. Fixture exterior view .....</b>	<b>5</b>
<b>3. Installation.....</b>	<b>6</b>
3.1 Connection to the mains .....	6
3.2 Installing barndoors and the gel frame .....	7
3.3 Rigging the fixture .....	9
3.4 DMX-512 connection.....	11
3.5. Wireless DMX operation .....	12
3.6. Stand-alone and Master/Slave operation .....	13
<b>4. Control menu map.....</b>	<b>14</b>
<b>5. Robin ParFect S1 - DMX chart.....</b>	<b>16</b>
<b>6. Control menu .....</b>	<b>17</b>
6.1 Addressing and master/slave setting (DMXA).....	17
6.2 Fixture information (Info) .....	17
6.3 Personality (Pers).....	18
6.4 Manual Control (Manual).....	18
6.5 Test program (Test Prg).....	18
6.6 Stand-alone (St Alone) .....	18
6.7 Special functions (Special).....	19
<b>7. RDM .....</b>	<b>20</b>
<b>8. Error and information messages .....</b>	<b>21</b>
<b>9. Technical Specifications .....</b>	<b>21</b>
<b>10. Maintenance and cleaning.....</b>	<b>24</b>
10.1 Replacing the fuse .....	25
10.2 Disposing of the product .....	25
<b>11. Photometric diagram.....</b>	<b>25</b>

**FOR YOUR OWN SAFETY, PLEASE READ THIS USER MANUAL CAREFULLY  
BEFORE POWERING OR INSTALLING YOUR Robin ParFect S1 !**

**Save it for future reference.**

This device has left our premises in absolutely perfect condition. In order to maintain this condition and to ensure a safe operation, it is absolutely necessary for the user to follow the safety instructions and warning notes written in this manual.

The manufacturer will not accept liability for any resulting damages caused by the non-observance of this manual or any unauthorized modification to the device.

Please consider that damages caused by manual modifications to the device are not subject to warranty.

**The Robin ParFect S1 was designed for indoor use and it is intended for professional application only. It is not for household use.**

## **1. Safety instructions**

**DANGEROUS VOLTAGE CONSTITUTING A RISK OF ELECTRIC SHOCK IS PRESENT WITHIN THIS UNIT!**

Make sure that the available voltage is not higher than stated on the rear panel of the fixture. This fixture should be operated only from the type of power source indicated on the marking label. If you are not sure of the type of power supplied, consult your authorized distributor or local power company.

WARNING! This unit does not contain an ON/OFF switch. Always disconnect power input cable to completely remove power from unit when not in use or before cleaning or servicing the fixture.

The power plug has to be accessible after installing the fixture. Do not overload wall outlets and extension cords as this can result in fire or electric shock.

Do not allow anything to rest on the power cord. Do not locate this fixture where the cord may be damaged by persons walking on it.

Make sure that the power cord is never crimped or damaged by sharp edges. Check the fixture and the power cord from time to time.

Refer servicing to qualified service personnel.

**This fixture falls under protection class I. Therefore this fixture has to be connected to a mains socket outlet with a protective earthing connection.**

Do not connect this fixture to a dimmer pack.

**Warning! Risk Group 2 LED product according to EN 62471  
LED light emission. Risk of eye injury. Do not look into the beam at a short distance from the front surface of the product. Do not view the light output with optical instruments or any device that may concentrate the beam.**

If the fixture has been exposed to drastic temperature fluctuation (e.g. after transportation), do not switch it on immediately. The arising condensation water might damage your device. Leave the device switched off until it has reached room temperature.

Do not shake the fixture. Avoid brute force when installing or operating the fixture.

This fixture was designed for indoor use only, do not expose this unit to rain or use near water.

This device is for professional use only. It is not for household use.

When choosing the installation spot, please make sure that the fixture is not exposed to extreme heat, moisture or dust.

Air vents and slots in the fixture's head and base are provided for ventilation, to ensure reliable operation of the device and to protect it from overheating.

**Do not block the LED array with any object when the fixture is under operation.**

The openings should never be covered with cloth or other materials, and never must be blocked.

This fixture should not be placed in a built-in installation unless proper ventilation is provided.

Only operate the fixture after having checked that the housing is firmly closed and all screws are tightly fastened.

Always use a secondary safety cable when mounting this fixture.

Make sure that the area below the installation place is blocked when rigging, derigging or servicing the fixture.

The fixture becomes very hot during operation. Allow the fixture to cool approximately 20 minutes prior to manipulate with it.

Operate the fixture only after having familiarized with its functions. Do not permit operation by persons not qualified for operating the fixture. Most damages are the result of unprofessional operation!

Please use the original packaging if the fixture is to be transported.

Please consider that unauthorized modifications on the fixture are forbidden due to safety reasons!

If this device will be operated in any way different to the one described in this manual, the product may suffer damages and the guarantee becomes void. Furthermore, any other operation may lead to dangers like short-circuit, burns, electric shock, crash etc.

## 2. Fixture exterior view

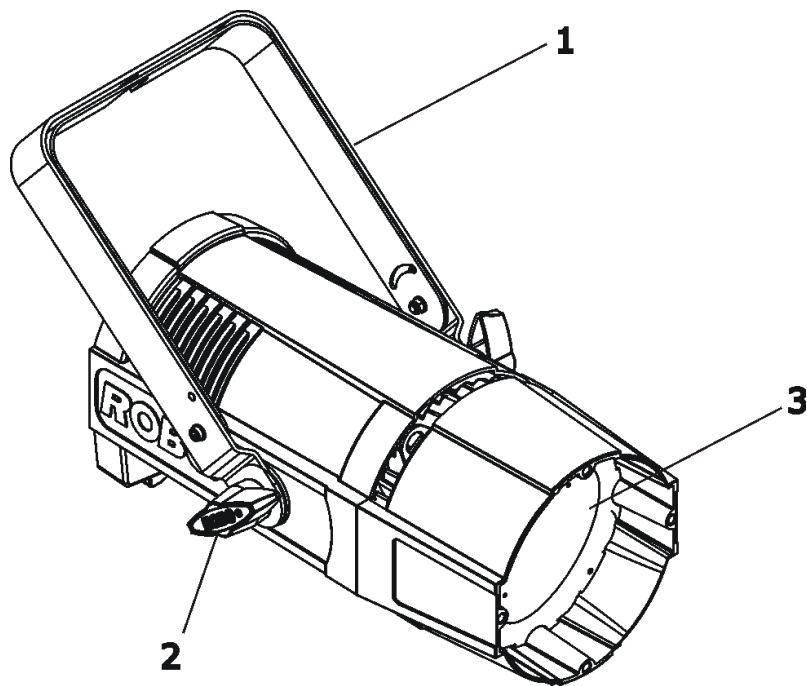

- 1 - Mounting yoke
- 2 - Tilt locks
- 3 - Optical system

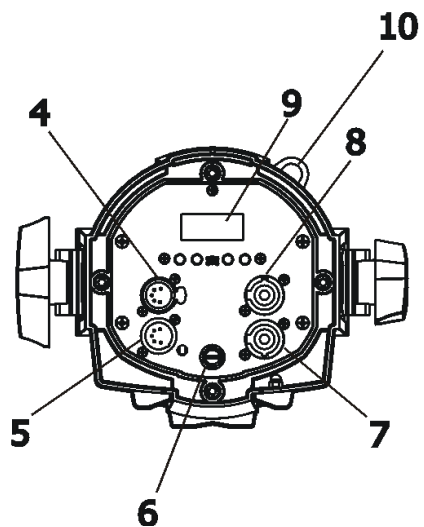

- 4 - DMX OUT
- 5 - DMX IN
- 6 - Fuse holder
- 7 - Mains IN
- 8 - Mains OUT
- 9 - Display and control buttons
- 10 - Safety wire attachment point

### 3. Installation



**Fixtures must be installed by a Qualified electrician in accordance with all national and local electrical and construction codes and regulation.**

#### 3.1 Connection to the mains

**For protection from electric shock, the fixture must be earthed!**

The ParFect S1 is equipped with auto-switching power supply that automatically adjusts to any 50-60Hz AC power source from 100-240 Volts.

Install a suitable plug on the power cord, note that the cores in the power cord are coloured according to the following table. The earth has to be connected!

If you have any doubts about proper installation, consult a qualified electrician.

Core (EU)	Core (US)	Connection	Plug Terminal Marking
Brown	Black	Live	L
Light blue	White	Neutral	N
Yellow/Green	Green	Earth	

This device falls under class one and must be earthed (grounded)!

Design of the ParFect S1 allows to connect several fixtures to AC mains power in one interconnected daisy chain using power input and throughput connectors. Needed daisy chain cords are stated in the chapter “Technical specifications “

The max. number of connected fixtures depends on the AC mains power voltage and fixture version:

EU version (CE)

19 fixtures at power supply= 230V

17 fixtures at power supply= 208V

9 fixtures at power supply= 120V

US version (cETLus)

12 fixtures at power supply= 230V

10 fixtures at power supply= 208V

6 fixtures at power supply= 120V

Actual numbers of fixtures may differ from values stated above as you have to take into account the length of supply cables, circuit breaker etc. at projecting of the fixtures installation.

Do not overload the supply line and the connecting leads.

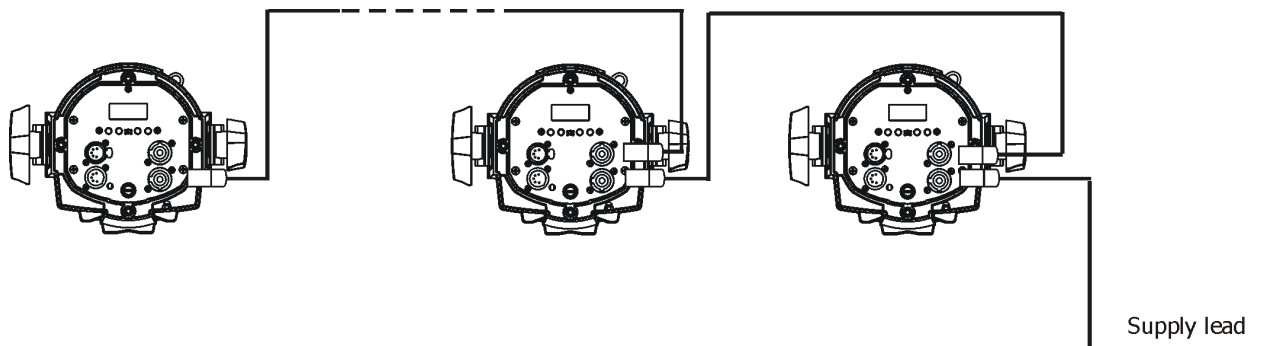

Wiring and connection work must be carried out by qualified staff!

## 3.2 Installing barndoors and the gel frame

**Disconnect the fixture from mains before barndoors and the gel frame installation**

1. Disconnect the fixture from mains.

2. Screw the accessory frame adaptor (1) on the Parfect S1 housing with the four screws M4x8 (2) and unlock the spring lock (3) via pushing this spring lock as show red arrows on the picture.

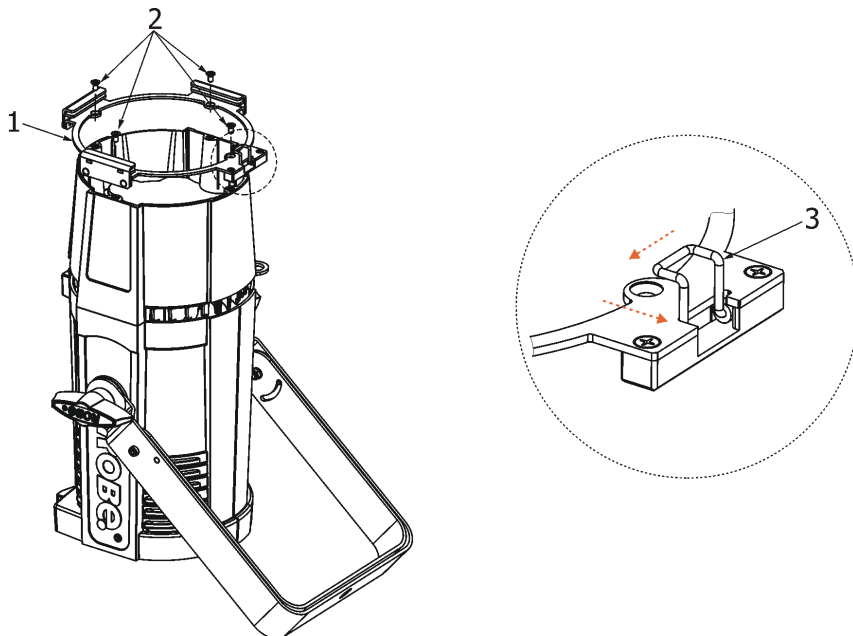

3. Insert the gel frame (4) into the bottom slots of the accessory frame adaptor (1).

4. Insert the barndoors (5) into the top slots of the accessory frame adaptor (1).

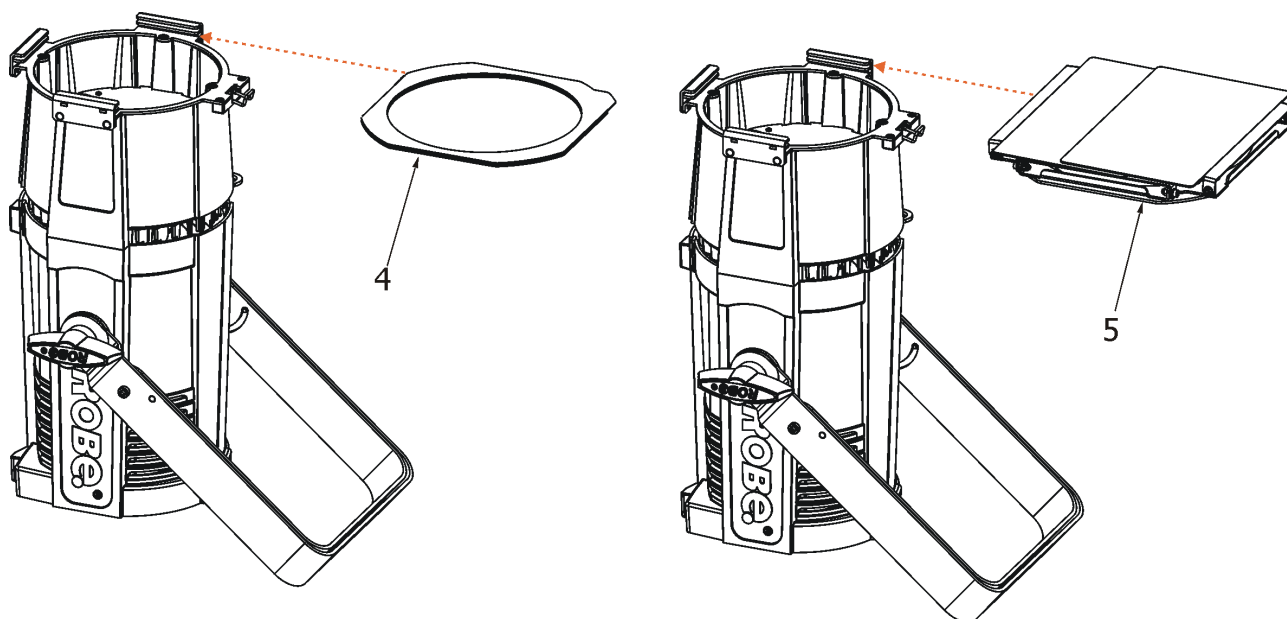

5. Secure both accessories by moving the spring lock (3) up as shows the red arrow on the picture.

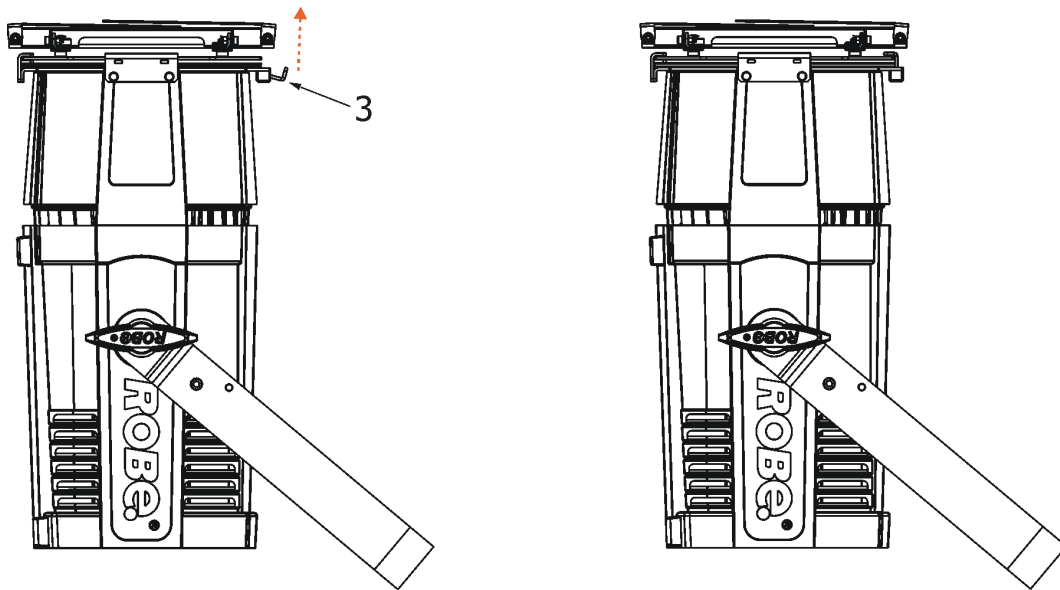

Note: the barndoors can be rotated to desired position and secured in this position via the securing screw (6).

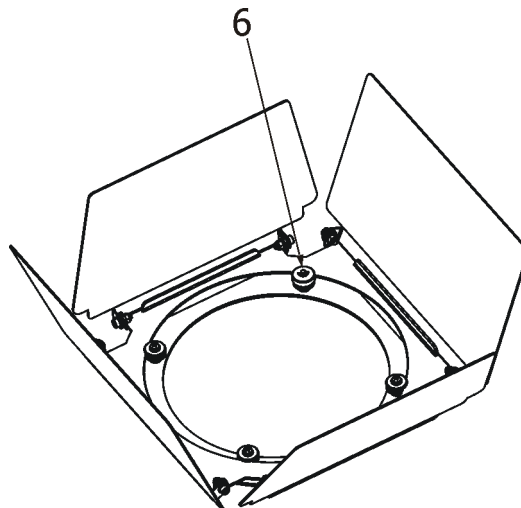



### 3.3 Rigging the fixture

A structure intended for installation of the fixture (s) must safely hold weight of the fixture(s) placed on it. The structure has to be certificated to the purpose.

The fixture (fixtures) must be installed in accordance with national and local electrical and construction codes and regulation.

***For overhead installation, the fixture must be always secured with a safety wire that can bear at least 10 times the weight of the fixture***

When rigging, derigging or servicing the fixture staying in the area below the installation place, on bridges, under high working places and other endangered areas is forbidden.

The operator has to make sure that safety-relating and machine-technical installations are approved by an expert before taking into operation for the first time and after changes before taking into operation another time.

The operator has to make sure that safety-relating and machine-technical installations are approved by a skilled person once a year.

Allow the fixture to cool for ten minutes before handling.

The projector should be installed outside areas where persons may walk by or be seated.

**IMPORTANT! OVERHEAD RIGGING REQUIRES EXTENSIVE EXPERIENCE**, including calculating working load limits, installation material being used, and periodic safety inspection of all installation material and the projector. If you lack these qualifications, do not attempt the installation yourself, but use a help of professional companies.

**CAUTION:** Fixtures may cause severe injuries when crashing down! If you have doubts concerning the safety of a possible installation, do not install the fixture!

The fixture has to be installed out of the reach of public.

The fixture must never be fixed swinging freely in the room.

**When installing the device, make sure there is no highly inflammable material (decoration articles, etc.) in a distance of min. 0.4 m.**

**CAUTION!**  
**Use an appropriate clamp to rig the fixture on the truss.**  
**Make sure that the device is fixed properly! Ensure that the structure (truss) to which you are attaching the fixtures is secure.**

The fixture can be placed by means of the unfolded mounting yoke on the stage floor or rigged on a truss (with folded mounting yoke) without altering its operation characteristics.

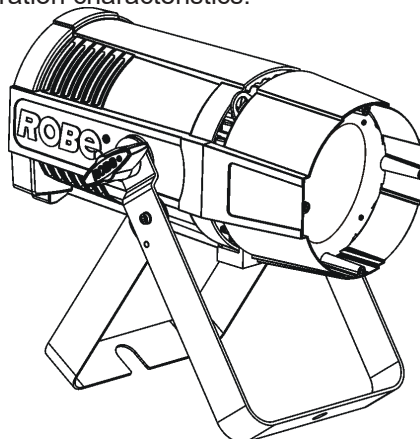

For overhead installation, install a safety wire that can hold at least 10 times the weight of the fixture. Use only safety wire with screw-on carabine. **Fasten the safety cable in the attachment point and around the truss as shown on the picture below.**

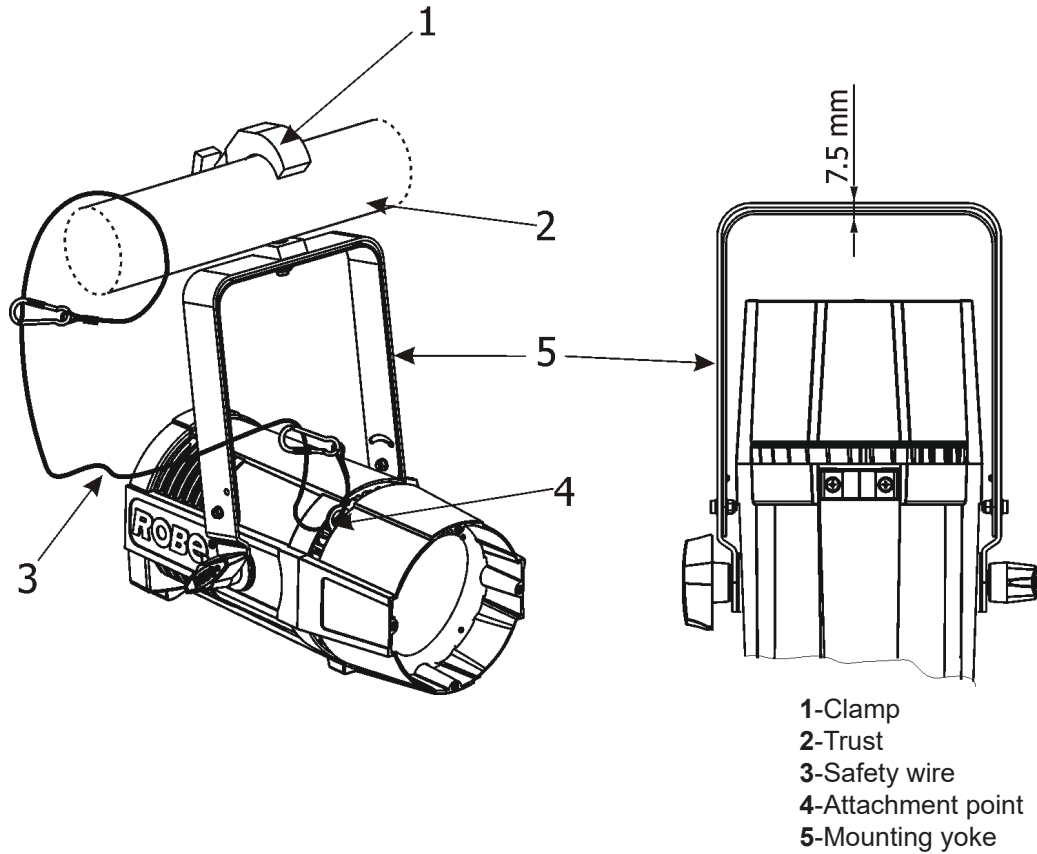

**When installing fixtures side-by-side, avoid illuminating one fixture with another!**

### 3.4 DMX-512 connection

The fixture is equipped with 5-pin XLR sockets for DMX input and output. Only use a shielded twisted-pair cable designed for RS-485 and 5-pin XLR-plugs and connectors in order to connect the controller with the fixture or one fixture with another.

#### DMX output

##### XLR socket:

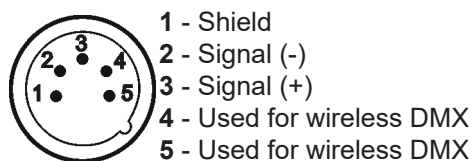

#### DMX input

##### XLRplug:

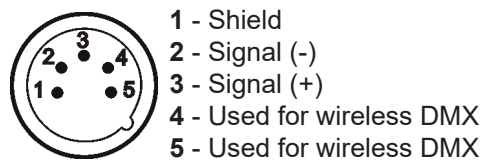

If you are using the standard DMX controllers, you can connect the DMX output of the controller directly with the DMX input of the first fixture in the DMX-chain. If you wish to connect DMX-controllers with other XLR-outputs, you need to use adapter-cables.

#### Building a serial DMX-chain:

Connect the DMX-output of the first fixture in the DMX-chain with the DMX-input of the next fixture. Always connect one output with the input of the next fixture until all fixtures are connected. Up to 32 fixtures can be interconnected.

**Caution:** At the last fixture, the DMX-cable has to be terminated with a terminator. Solder a 120  $\Omega$  resistor between Signal (-) and Signal (+) into a 5-pin XLR-plug and plug it in the DMX-output of the last fixture.

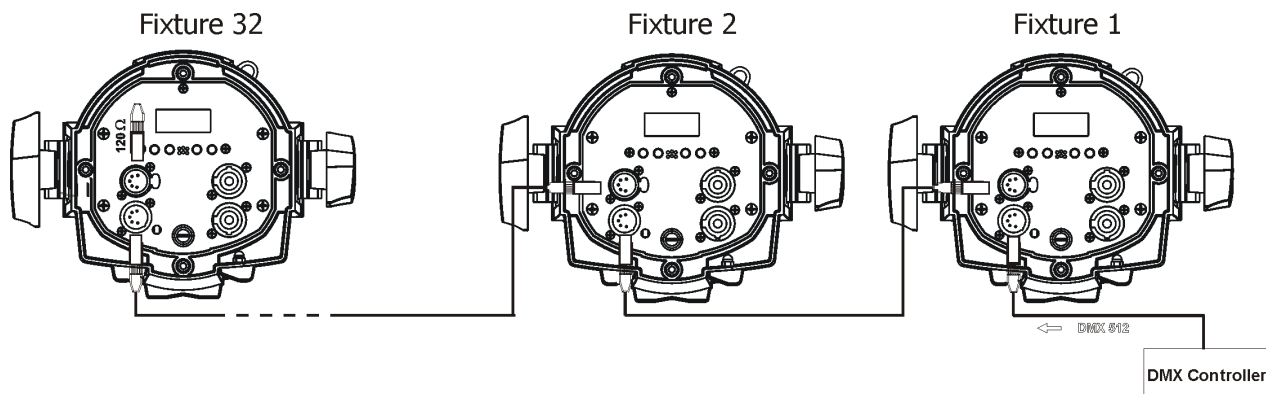

### 3.5. Wireless DMX operation

The external ROBE Wireless CRMX Dongle for compact ROBIN fixtures allows receiving wireless DMX. This device is equipped with the Lumen Radio CRMX module and antenna for receiving DMX signal. CRMX module operates on the 2.4 GHz band.

ROBE Wireless CRMX Dongle for compact ROBIN fixtures

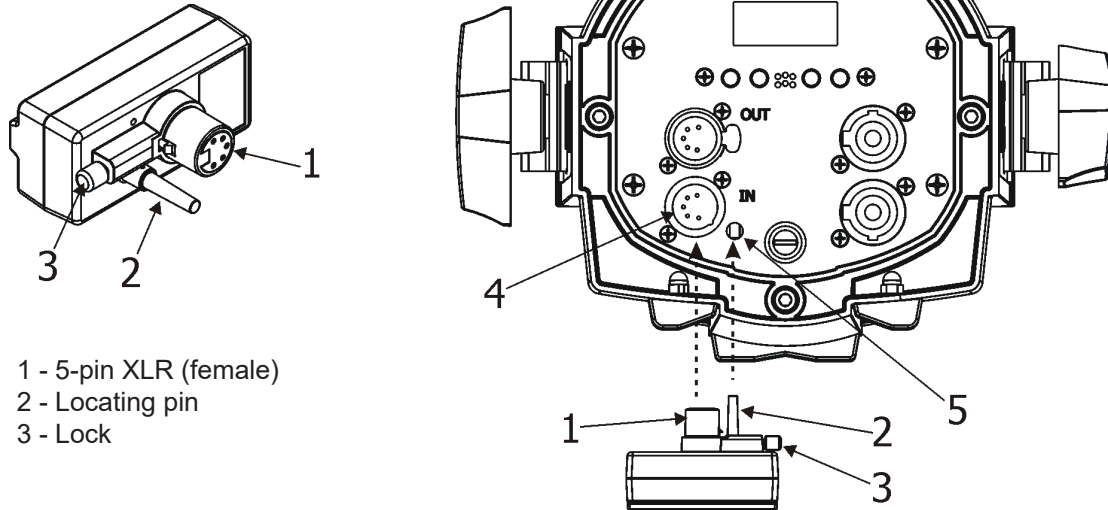

Push in the 5-pin XLR plug (1) into 5-pin XLR socket (4) and simultaneously locating pin (2) into hole (5) in the fixture. In this way the wireless DMX module is connected with the fixture.

NOTE: when you disconnecting the DMX wireless module from the fixture, press and hold lock (5) during getting the wireless module out.

#### To link the fixture with DMX transmitter.

The fixture can be only linked with the transmitter by running the link procedure at DMX transmitter .

After linking , the level of DMX signal ( 0-100 %) is displayed in the menu item "Stat" (Special -->Vireless -->Stat).

#### To unlink the fixture from DMX transmitter.

The fixture can be unlinked from receiver via the menu item " Unlink" (Special-->Vireless -->Unlink.).

### 3.6. Stand-alone and Master/Slave operation

The fixtures on a data link are not connected to the controller but can execute pre-set programs which can be different for every fixture. To set the program to be played, see the **"Mast/Sla"** menu (DMXA ----> Mast/Sla). The Stand-alone operation can be applied to the single fixture or to multiple fixtures operating synchronously. Synchronous operation of multiple fixtures requires that they must be connected on a data link and one of them is set as a master (master mode) and the rest as the slaves (slave mode). To set the fixture as the master or the slave, see the **"Mast/Sla"** menu.

The master fixture starts simultaneous program start in the other slave fixtures. All fixtures have a definite, synchronized starting point when playing back their programs. Every slave runs its program according to the program number of the master. E.g. if the master runs program number 3, all slaves run their programs number 3. Note: if the option "Play Master" is selected at the fixture, this slave will play master's program, e.g. number 3, instead of its own program no.3.

Every fixture runs its program repeatedly, starting the program step No.1 when requested by the master.

If the slave fixture has a shorter program length, it will continuously repeat its program until the master fixture finishes its own program and restarts its program running (slave 1- prog. step 3 will not be finished) -see the picture below.

If the slave fixture has a longer program length, it will restart at prog. step 1 before it completes all its prog. steps (slave 2 - prog. step 5 will not be played) - see the picture below.

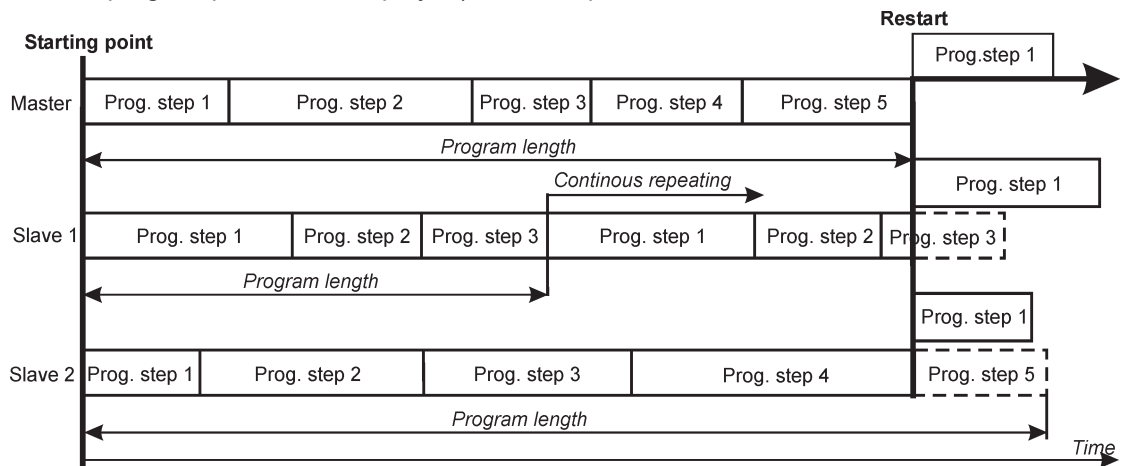

**Note:** Disconnect the fixtures from the DMX controller before master/slave operating, otherwise data collisions can occur and fixtures will not work properly!

## 4. Control menu map

Default settings=**Bold print**

Level 1	Level 2	Level 3	Level 4	Level 5	Level 6	Level 7
<b>DMXA</b>	Set DMXA	001-255				
	DMX Pres	<b>Mode 1</b>				
		Mode 2				
		Mode 3				
	Mast/Sla	Off				
		Master	Play Prog 1			
			Play Prog 2			
			Play Prog 3			
		Slave	Play Master			
			Play Slave			
<b>Info</b>	POn Time	Total				
		Reset				
	DMX In	Stro.	0-255			
		Dimm.	0-255			
		Dim F	0-255			
	Temp	Current				
		Highest				
		High Res				
	Sw Ver	IC-1				
		IC-2				
<b>Pers</b>	DMX Pres	<b>Mode 1</b>				
		Mode 2				
		Mode 3				
	Display	Turn				
		On/Off T	On, <b>Off</b>			
		Contrast	0-100%			
		Backlight	0-100%			
	Dimm	Lin				
		<b>Sql</b>				
	Mic Sens	0... <b>10</b> ...19				
	Fans	<b>Auto</b> , High, Silent				
	Temp Uni	°C, °F				
	I Ef Pos	Stro				
		Dimm.				
		Dim F				
		Store				
	Defaults					
<b>Manual</b>	Stro	0-255				
	Dimm	0-255				
	Dim F	0-255				
<b>Test Prg</b>						
<b>Sta Alone</b>	Music T	On, <b>Off</b>				
	Auto Run	<b>Off</b>				
		Prog 1				
		:				
		Test				
	Pr Play	Prog 1				

		:				
<b>Level 1</b>	<b>Level 2</b>	<b>Level 3</b>	<b>Level 4</b>	<b>Level 5</b>	<b>Level 6</b>	<b>Level 7</b>
		Test				
	Pr Edit	Prog 1	Step 1	Stro.		
		Prog 2	:	:		
		Prog 3	Step 40	F.Tim	0-25.5	
				S.Tim	0-25.5	
				COPY		
				Prg En	1-40	
<b>Special</b>	RDM Low					
	RDM Hight					
	Wireless	Stat				
		Unlink				
	Sw Upd	On, <b>Off</b>				

## 5. Robin ParFect S1 - DMX chart

Version 1.2

**Mode 1- Basic 8 bit, Mode 2- Extended 16bit, Mode 3 - Strobe mode**

Mode/Channel			Value	Function	Type of control
1	2	3			
-	-	1	0-31 32-63 64-95 96-127 128-143 144-159 160-191 192-223 224-255	<b>Shutter/Strobe</b> Shutter closed Shutter open Strobe effect from slow--> fast Shutter open Opening pulses in sequences from slow--> fast Closing pulses in sequences from fast--> slow Shutter open Random strobe effect from slow --> fast Shutter open	step step proportional step proportional proportional step proportional step
1	1	2	0-255	<b>Dimmer (8 bit)</b> Dimmer intensity from 0% to 100%	proportional
-	2	3	0-255	<b>Dimmer fine (16 bit)</b> Fine dimming	proportional



## 6. Control menu

The ParFect S1 is equipped with 2-row LCD display which allows to set the fixture's behaviour according to your needs, obtain information on its operation, test its various parts and lastly program it, if it has to be used in a stand-alone mode.

Control panel:

[ESCAPE] button used to leave the menu without saving changes.

[NEXT] , [PREV] buttons for moving between menu items and for value adjusting.

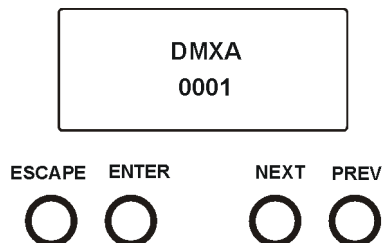

Note:

If you press and hold the [ESCAPE] and the [NEXT] button together, the fixture will start to light. (without connected DMX)

[ENTER] button used to enter the selected menu (menu item) and to confirm adjusted value.

After switching the fixture on, display shows current DMX address.

Note: to rotate menu 180 degrees from current orientation, press and hold the [ESCAPE] button.

### 6.1 Addressing and master/slave setting (DMXA)

**Set DMXA**- Use this menu item to set the DMX start address of the fixture, which is defined as the first channel from which the ParFect S1 will respond to the controller.

If you set, for example, the address 12, the ParFect S1 will use channels 12 - 14 for control (if Mode 3 is selected). Please, be sure that you do not have any overlapping channels in order to control each ParFect S1 correctly and independently from any other fixture on the DMX data link.

If there is no data received at the DMX input, the display will start to flash "0001" with actually stored DMX address.

**DMX Pres** - **DMX preset**. Use the menu to select desired channel mode.

**Mode 1** - 1 control channels

**Mode 2** - 2 control channel

**Mode 3** - 3 control channel

**Mast/Sla** - Use this menu item to set the fixture as a master or slave.

**Master** - The fixture will behave as the master and can play one of the 3 programs (**Prog 1**, **Prog 2**, **Prog 3**) in a loop.

**Slave** - The fixture will behave as the slave and can play either master's program (**Play Master**) or its respective program (**Play Slave**).

### 6.2 Fixture information (Info)

**Pon Time** - **Power on time**. Select this menu to read the number of fixture operation hours.

**Total** - The item shows the total number of the operation hours since the ParFect S1 has been fabricated.

**Reset** - The item shows the number of the operation hours that the ParFect S1 has been powered on since the counter was last reset.

In order to reset this counter to 0, press and hold both [NEXT] and [PREV] buttons and the [Enter] button at the same time.

**DMX In** - **DMX readout**. The menu is used to read DMX values of each channel received by the fixture.

**Temp** - **Temperature**. The menu shows temperature in the LED module.

**Current** - A current temperature of the LED module.

**Highest** - A maximum temperature of the the LED module since the fixture has been fabricated.

**High Res** - A maximum temperature of the the LED module since the counter was last reset.

In order to reset this counter, press and hold both [NEXT] and [PREV] buttons and the

[Enter] button at the same time.

**Sw Ver - Software versions.** Select this item to read the software version of the fixture modules.

**IC-1** - A display processor.

**IC-2** - A LED control processor.

## 6.3 Personality (Pers)

**DMX Pres - DMX preset.** Use the menu to select desired channel mode.

**Mode 1** - 1 control channels

**Mode 2** - 2 control channel

**Mode 3** - 3 control channel

**Display - Display adjusting.** This menu allows you to adjust the display behaviour.

**Turn** - This function rotates menu 180 degrees from current orientation.

**On/Off T** - This function allows you to keep the display permanent on or turn it off two minutes after last pressing any button on the control panel.

**Contrast** - Use this function to adjust contrast of the display (0-100%).

**Backlight** - Use this function to adjust backlight of the display (0-100%).

**Dimm - Dimmer curve.** Use the menu to select desired dimmer curve, linear (Lin) or square law (Sql)

**Mic Sens - Microfon sensitivity.** Enter the menu if you want to adjust the microphone sensitivity ( 1-max., 19-min.).

**Fans - Fan mode.** Use the menu to set the fixture's fan to max. power mode ("**High**") or to auto-control mode ("**Auto**"). The last option ("**Silent**") reduces speed of the fan to keep the noise of the fan at min. level. Reduced light output will occur at higher ambient operating temperatures (above 35°C):

Ambient temperature (°C)	Light output (%)
35	100
40	84
45	76

**Temp Uni - Temperature unit.** Use the menu item to change temperature unit from °C to °F.

**I Ef Pos - Init effect positions.** Use the menu to set all effects to the desired positions at which they will stay after switching the fixture on without DMX signal connected.

**Defaults** - The menu item allows to set all fixture parameters to the default (factory) values.

## 6.4 Manual Control (Manual)

Use the menu to control all fixture channels by means of the control panel.

## 6.5 Test program (Test Prg)

Use this menu to to run a special demo-test sequences without an external controller, which will show you some possibilities of using the ParFect S1.

## 6.6 Stand-alone (St Alone)

The ParFect S1 offers three user-editable programs (Prog 1-Prog 3), each up to 40 steps.

**Music T - Music trigger.** Select this function to enable the sound control of the running program via the built-in microphone.

**Auto Run - Presetting playback.** This function allows you to select the program which will be played in the stand-alone mode after switching the fixture on. Selected program will be played continuously in a loop.

**Off** - The option disables "Auto Run" function.

**Prog 1- Test** - Selected program will start running after switching the fixture on.

**Pr Play - Playing program.** Select this menu to run a desired program in a loop.

**Prog 1- Test** - Select the program you wish and press [ENTER]. The selected program starts running. By Pressing the [ENTER] again, the program pauses running. The speed of the running program can be changed by means of the [NEXT] and [PREV] buttons (100%-default value).

Note: adjusted program speed is saved into the fixture and will not be changed until another program speed adjusting is performed or default values are loaded.

**Pr Edit - Editing program.** Select this menu to edit or create the program. The ParFect S1 has three user-editable programs, each up to 40 steps. Each program step has a step time - during which effects last in the current step and a fade time- during which effects move to new positions.

To edit program:

1. Press [NEXT] or [PREV] to select the menu "Pr Edit" and press [ENTER].
2. Press [NEXT] or [PREV] to select the desired program and press [ENTER] button.
3. Press [NEXT] or [PREV] to select the desired program step and press [ENTER] button.
4. Press [NEXT] or [PREV] to select the desired item and press [ENTER] button. Now you can edit by [NEXT] or [PREV] buttons the DMX value (0-255) for selected item:

Prg En. a total number of the program steps (value 1-40). This value you should be set before starting of programming (e.g. if you want to create program with the 10 steps, set Prg En=10).

Stro a strobe/shutter

Dimm a dimmer coarse

F.Tim a fade time (0-25.5 sec)

S.Tim a step time (0-25.5 sec)

COPY copying the current prog. step to the next prog. step

5. Press [ENTER] button to confirm adjusted value .

6. Press [ESCAPE] button, select next prog. step, press [ENTER] button and repeat steps 4 - 5).

## 6.7 Special functions (Special)

**RDM Low** - This menu item shows the first part of the RDM identification code.

**RDM High** - This menu item shows the second part of the RDM identification code.

**Wireless** - **Wireless DMX information.** The menu allows to read some information about Wireless DMX operation

**Stat - Wireless status.** Use the menu to read wireless DMX status.

**Unlink** - use this item to unlink fixture from wireless DMX.

**Sw Upd** - **Software update.** The menu item allows you to update software in the fixture via either serial or USB port of PC.

The following are required in order to update software:

- PC running Windows 7/8/10 or Linux
- Update software
- Flash cable RS232/DMX P/N13050624 (if you want to use a serial port of PC)
- Robe Universal Interface (if you want to use an USB port of PC)

Note 1: Software update should execute a qualified person. If you lack qualification, do not attempt the update yourself and ask for help your ROBE distributor.

Note 2: DMX address, , programs 1-3 and all items in the menu "Pers" will be set to their default (factory) values after software update.

*To update software in the fixture:*

I. Installation of the update software.

1. Update Software available from the ROBE web site at [WWW.robe.cz](http://WWW.robe.cz).
2. Make a new directory ( e.g. Robe\_Uploader) on your hard disk and download the software to it.
3. Unpack the program to the directory.

II.Fixture software updating.

1. Determine which of your ports is available on your PC and connect it:

- with the DMX input of the fixture if you are using the flash cable RS232/DMX
- with the USB input of the Robe Universal Interface if you are using the USB cable. Connect DMX output of the Robe Universal Interface with the fixture via a standard DMX cable.

Turn both the computer and the fixture on. Make sure the lamp is switched off (only if the fixture has a lamp).

2. Switch the fixture to the updating mode (Special -> "SW Upd" -> On).

Note: If you do not want to continue in software update, you have to switch off and on the fixture to escape from this menu.

We recommend to cancel all running programs on PC before starting the software update.

3. Run the Software Uploader. Select desired COM and then click on the Connect button.

(Select COM if the serial port is used or Robe Universal Interface if the USB port is used).

If the connection is OK, click on the "Start Uploading button" to start uploading. It will take several minutes to perform software update.

If the option "Incremental Update" is not checked, all processors will be updated (including processors with the same software version).

If you wish to update only later versions of processors, check the "Incremental Update box".

Avoid interrupting the process. Update status is being displayed in the Info Box window.

When the update is finished, the line with the text "The fixture is successfully updated" will appear in this window.

Note: In the case of an interruption of the upload process (e.g. power cut), the fixture keeps the updating mode and you have to repeat the software update again.

## 7. RDM

This fixture supports RDM operation. RDM (Remote Device Management) is a bi-directional communications protocol for use in DMX512 control systems, it is the new open standard for DMX512 device configuration and status monitoring.

The RDM protocol allows data packets to be inserted into a DMX512 data stream without adversely affecting existing non-RDM equipment. By using a special „Start Code,“ and by complying with the timing specifications for DMX512, the RDM protocol allows a console or dedicated RDM controller to send commands to and receive messages from specific moving lights.

RDM allows explicit commands to be sent to a device and responses to be received from it.

The list of commands for the ParFect S1 is the following.

Parameter ID	Discovery command	SET command	GET command
DISC_UNIQUE_BRANCH	*		
DISC_MUTE	*		
DISC_UN_MUTE	*		
DEVICE_INFO			*
SUPPORTED_PARAMETERS			*
SOFTWARE_VERSION_LABEL			*
DMX_START_ADDRESS		*	*
IDENTIFY_DEVICE		*	*
DEVICE_MODEL_DESCRIPTION			*
MANUFACTURER_LABEL			*
DEVICE_LABEL		*	*
SENSOR_DEFINITION			*
SENSOR_VALUE			*
DISPLAY_INVERT		*	*
DISPLAY_LEVEL		*	*
DEVICE_RESET		*	
DMX_PERSONALITY		*	*
DMX_PERSONALITY_DESCRIPTION			*
STATUS_MESSAGES			*
STATUS_ID_DESCRIPTION			*
DEVICE_HOURS			*
PARAMETER_DESCRIPTION			*

ROBE_DMX_INPUT		*	*
ROBE_WIRELESS_UNLINK		*	

## 8. Error and information messages

### **Short Err**

The message informs you that short circuit has occurred on the LED PCB.

## 9. Technical Specifications

### **Electrical**

Power supply:.....electronic auto-ranging  
 Input voltage range:..... supply 100-240V, 50-60Hz  
 Fuse:.....T 3.15A/250V ~  
 Max. power consumption :.....150W (I=0.65A @ 230V, power factor=0.94)  
 Mains input: 16A max. (CE ), 10A max. (cETLus)  
 Mains output: 15A max. (CE ), 9A max. (cETLus)

### **Optic**

Light source: LED COB  
 Min LED life expectancy: 60.000 hours  
 Beam angle: 12°, 23° (optional diffuser 28° included)  
 Colour temperature: 2.700 K, 3.000K, 4.000K or 6.000 K  
 CRI: 96 (2700K), 93 (3000K), 80 (4000K), 82 (6000K)

### **Strobe**

Strobe effect with variable speed (0.3 - 20Hz)  
 Random strobe pulse-effect with variable speed  
 Opening/closing pulse effect with variable speed

### **Dimmer**

Smooth dimmer from 0 - 100 %

### **Control**

2-row LCD display & 4 buttons  
 Readout fixture usage, receiving DMX values, temperatures, etc  
 Built-in analyzer for easy fault finding, error messages  
 Built-in demo sequences  
 Silent fan cooling,  
 Stand-alone operation  
 3 user editable programs, each up to 40 steps  
 Supported protocols: USITT DMX 512, RDM,  
 Support of RDM (Remote Device Management)  
 3 DMX modes (1,2,3 control channel)

### **External Wireless DMX/RDM module (option)**

Compliance with USITT DMX-512 (1986 & 1990) and 512-A  
 Full DMX fidelity and frame integrity  
 Auto sensing of DMX frame rate and frame size  
 <5ms DMX latency  
 Operational frequency range of 2402-2480 MHz  
 Producer: LumenRadio

## Connection

DMX data in/out: Locking 5-pin XLR

AC power input: Chassis connector Neutrik PowerCon, A-type, NAC3MPA

AC power output: Chassis connector Neutrik PowerCon, B-type, NAC3MPB

## Rigging

Mounting horizontally or vertically via mounting yoke (360° tilt range)

## Temperatures

Maximum ambient temperature : 40° C

Maximum surface temperature : 80° C (at LEDs heat sink)

## Distances

Min. distance from flammable surfaces: 0.4 m

Min. distance to lighted object: 0.8 m

## Total heat dissipation

680 BTU/h (calculated)

## Weight (net):

4.5 kg

## Dimensions (mm)

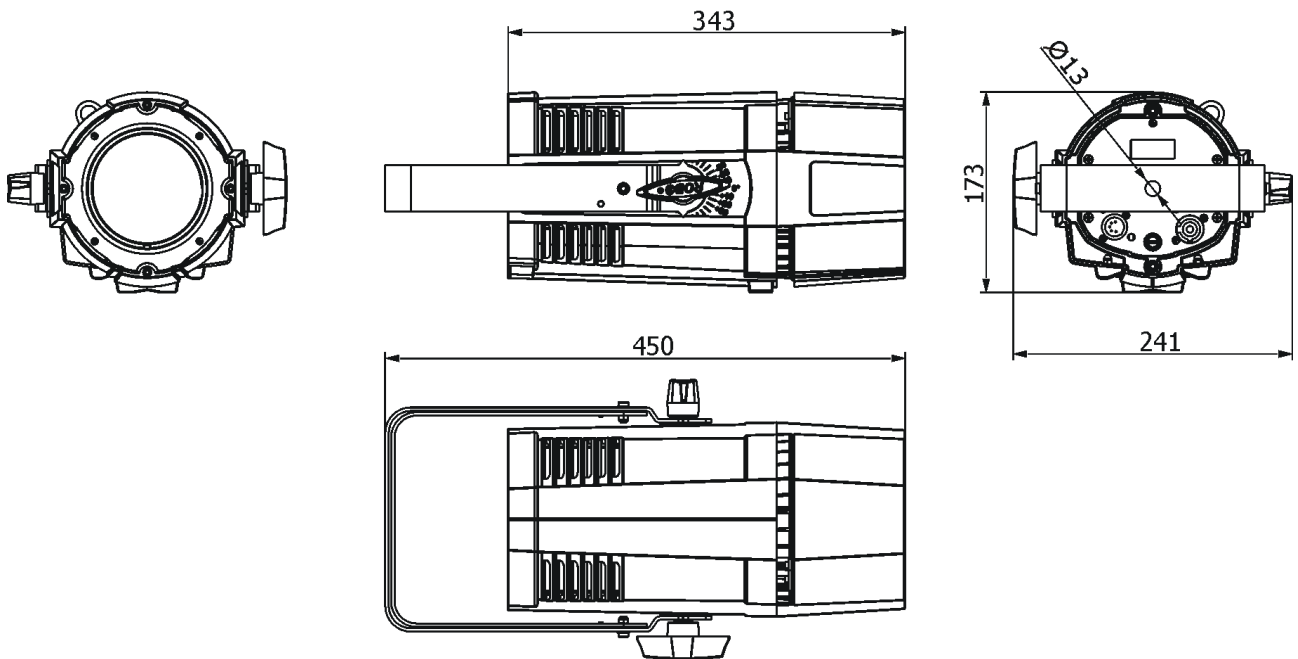

## ROBE Wireless CRMX Dongle for compact ROBIN fixtures

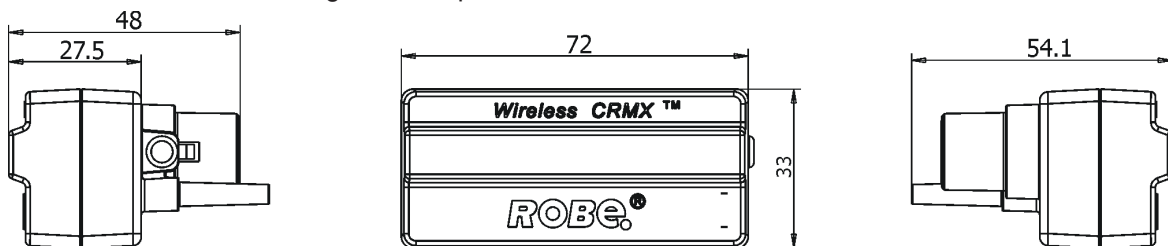

## Accessories\*

- (P/N 1098 0242) Diffuser 28° for Robin Parfect S1/SB1
- (P/N 10980193) Accessory frame adaptor black
- (P/N 10980205) Accessory frame adaptor white
- (P/N 10980204) Gel Frame black
- (P/N 10980207) Gel Frame white
- (P/N 10980237) Barndoor for Parfect S1 black (barndoor with aperture 90x90 mm)
- (P/N 10980241) Barndoor for Parfect S1 white (barndoor with aperture 90x90 mm)

\* Colour of accessories depends on colour of fixture. Only one colour of accessories is supplied with fixture.

## Optional accessories

- (P/N 10980127) Robe Wireless CRMX-LB100
- (P/N 10980206) Barndoor for Parfect 100 white (barndoor with aperture 157x157 mm)
- (P/N 10980189) Barndoor for Parfect 100 black (barndoor with aperture 157x157 mm)
- (P/N13051731) Mains Cable PowerCon In/open ended, 2m
- (P/N 13051724) Mains Cable PowerCon In/Schuko, 2m
- (P/N 13051725) Mains Cable PowerCon In/CEE 16A, 2m
- (P/N 13051726) Mains Cable PowerCon In/US, 2m
- (P/N 13051727) Daisy Chain PowerCon In/Out, EU, 2m
- (P/N 13051728 ) Daisy Chain PowerCon In/Out, US, 2m
- (P/N 1098 0243) Diffuser 40° for Robin Parfect S1/SB1
- (P/N 1098 0244) Diffuser 50° for Robin Parfect S1/SB1
- (P/N 1098 0245) Diffuser 62°x 46° for Robin Parfect S1/SB1
- (P/N 1098 0246) Diffuser 70°x 48° for Robin Parfect S1/SB1
- (P/N 17030386) Doughty Trigger Clamp
- (P/N 99011963) Safety wire 35 kg

## Barndoors dimensions (min. apertures - square) in mm

Barndoor with aperture 90x90

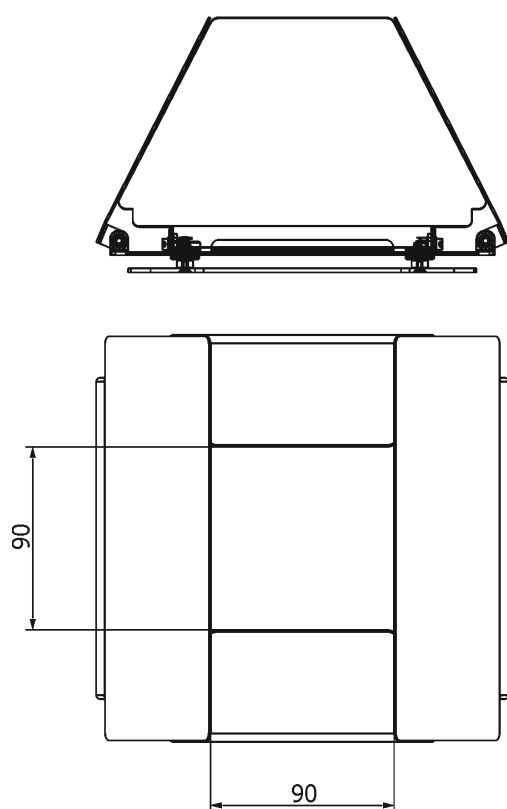

Barndoor with aperture 157x157

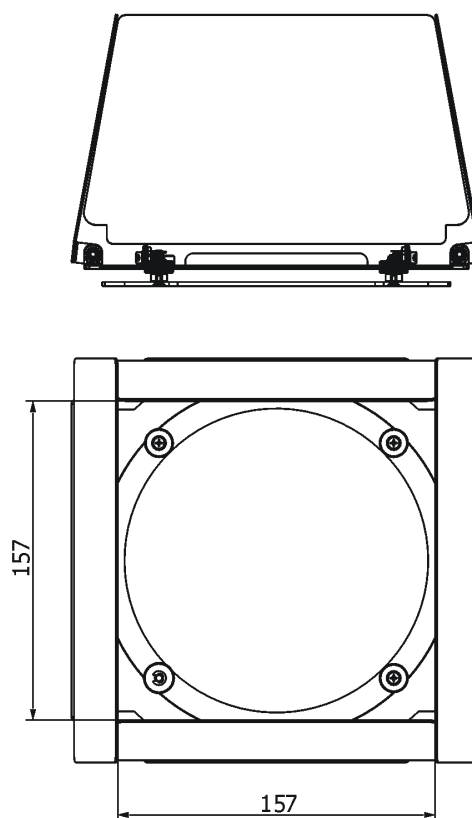



## 10. Maintenance and cleaning

### **DANGER !**

**Disconnect from the mains and allow to cool completely before starting any maintenance work**

A soft lint-free cloth moistened with any good glass cleaning fluid is recommended, under no circumstances should alcohol or solvents be used!

It is absolutely essential that the fixture is kept clean and that dust, dirt and smoke-fluid residues must not build up on or within the fixture. Otherwise, the fixture's light-output will be significantly reduced. Regular cleaning will not only ensure the maximum light output, but will also allow the fixture to function reliably throughout its life. Front transparent cover may require monthly cleaning as smoke-fluid tends to building up residues, reducing the light-output very quickly. The cooling fan should be cleaned according to the situation (at least annually).

The interior of the base should be cleaned at least annually using a vacuum-cleaner or an air-jet.

More complicated maintenance and service operations are only to be carried out by authorized distributors.

Disassembly of the Perfect S1 23°:

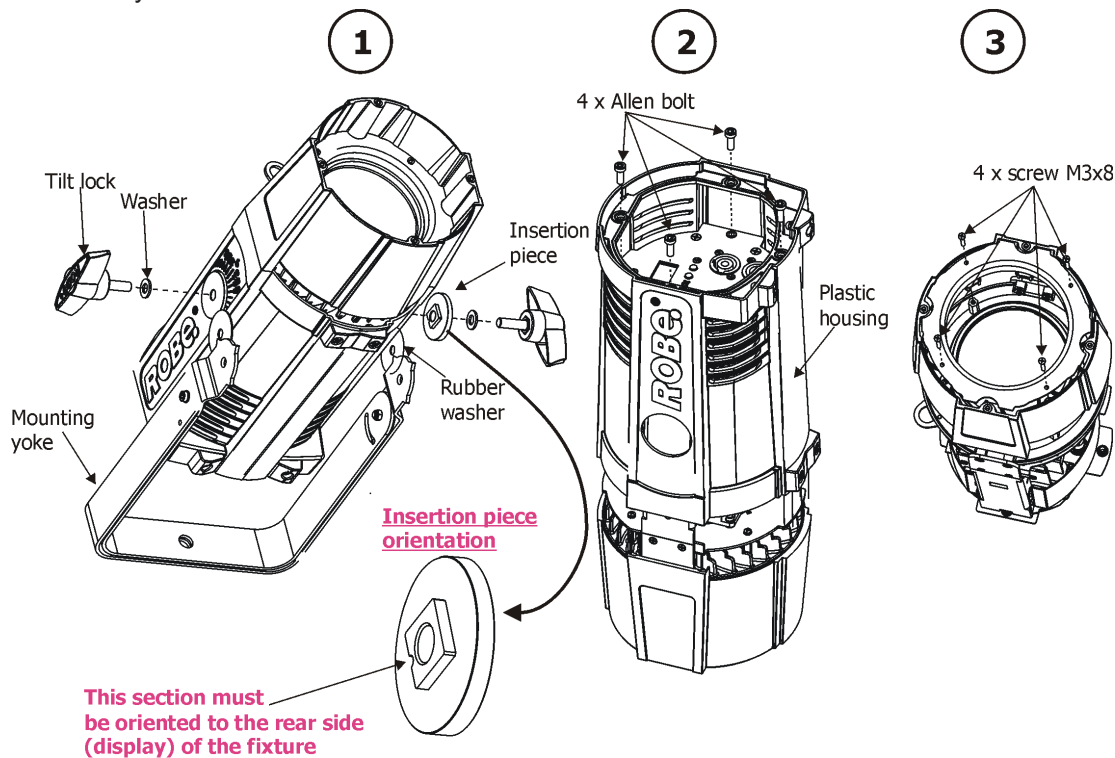

Disassembly of the Perfect S1 12°:

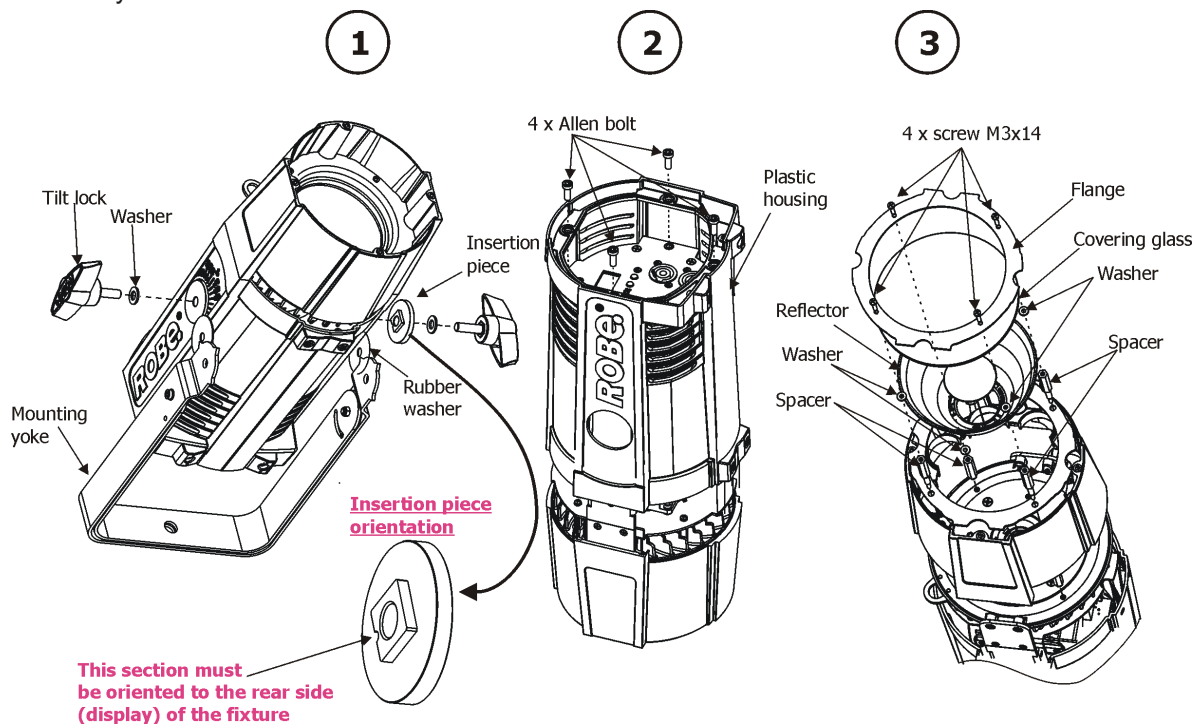



Important: The correct order of parts at the mounting yoke assembly is: insertion piece+rubber washer+yoke+metal washer+tilt lock (on both sides of the device). The correct orientation of the insertion piece must be kept.

## 10.1 Replacing the fuse

Replace the fuse by a fuse of the same type and rating only.

**Before replacing the fuse, unplug mains lead!**

- 1) Remove the fuse holder on the rear panel of the base with a fitting screwdriver from the housing(anti-clockwise).
- 2) Remove the old fuse from the fuse holder.
- 3) Install the new fuse in the fuse holder (only the same type and rating).
- 4) Replace the fuseholder in the housing and fix it.

## 10.2 Disposing of the product

To preserve the environment please dispose or recycle this product at the end of its life according to the local regulations and codes.

## 11. Photometric diagram

**Beam angle 23°, Colour temperature 6000K**

**Without diffuser**

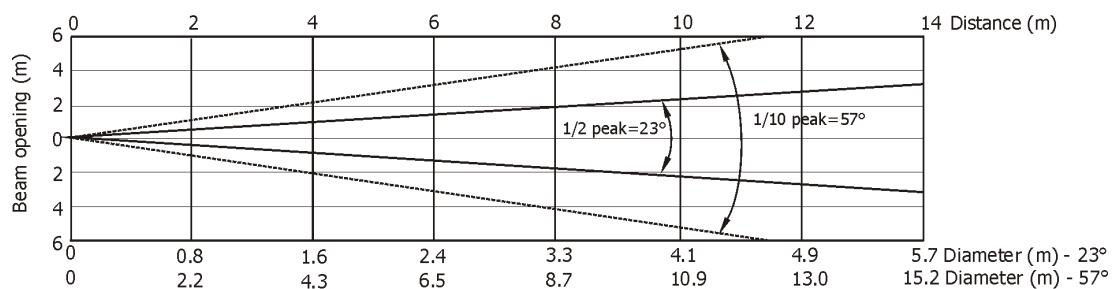

Distance (m)	2	4	5	6	8	10	12	14	
White 6000K	7375/685	1844/171	1180/110	819/76	461/43	295/27	205/19	150/14	Intensity (center) Lux/Footcandles

### Illuminance distribution

Distance=5m

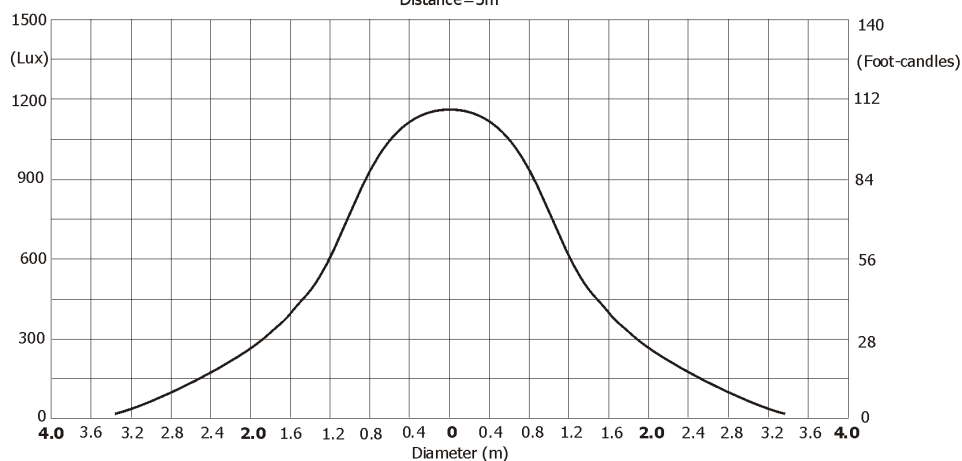

*Copyright © 2015-2018 Robe Lighting - All rights reserved  
Specifications are subject to change without notice.  
April 9, 2018*

*Made in ROBE Lighting s.r.o., Palackého 416, 757 01 Valašské Meziříčí, Czech Republic*

