

Introduction

The *Octopod* intelligent LED color system generates and controls millions of colors and produces a wide variety of lighting effects. Chase, strobe and mix the colors of the *Octopod's* eight LED fixtures in three operating modes (Stand-alone, DMX or Sound-active). This solid-state lighting system has been designed for easy installation and safe, energy-efficient, long-life operation.

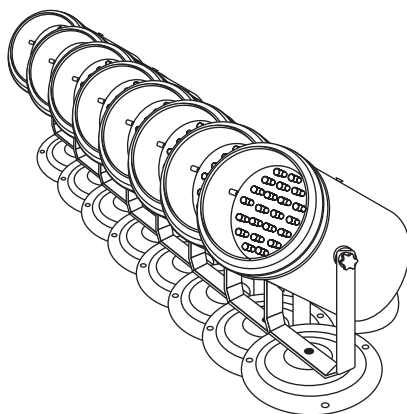
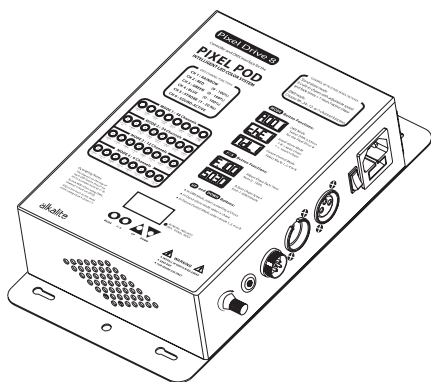

THE SYSTEM INCLUDES:

- 8 *Octopod* LED fixtures
- 8 DC/Signal cables
- 1 *Pixel Drive 8* controller/DMX interface
- 1 Power cord
- 1 Installation Guide

ADDITIONAL ITEMS NOT INCLUDED:

- DMX controller
- 3-pin DMX cable

Setup

Connect the *Octopod* fixtures using the supplied DC/Signal cables and set each fixture address as illustrated below.

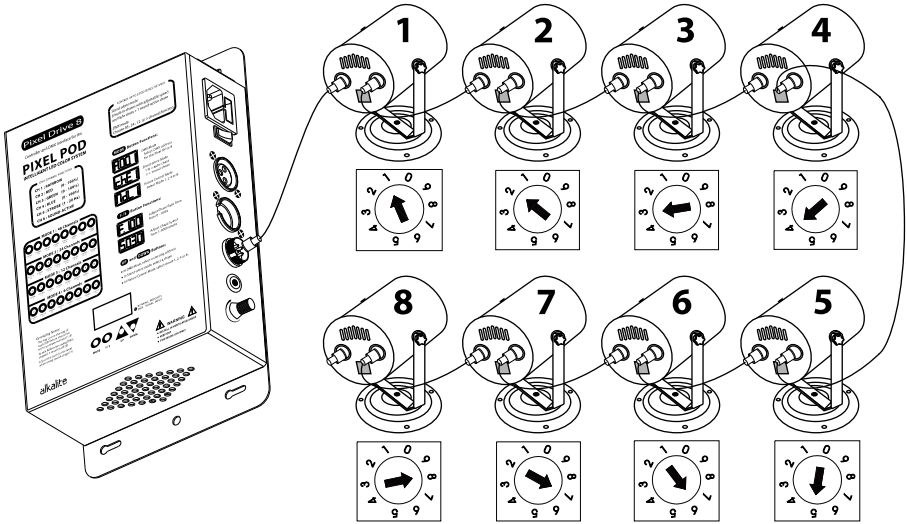

Front and Side Panel Functions

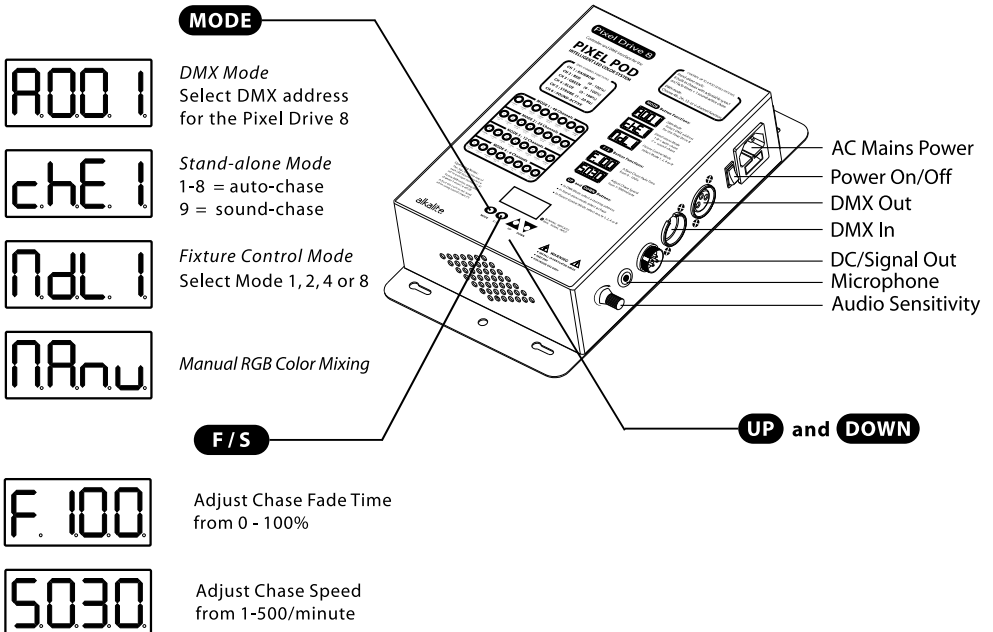

Cautions

FOR INDOOR USE ONLY
KEEP DRY
INSTALL ONLY IN WELL-VENTILATED AREAS
DO NOT ATTEMPT TO OPEN THE CONTROLLER OR FIXTURES
NO USER SERVICEABLE PARTS

DANGER: Ensure that main power supply is off before installing or wiring the *Octopod* system.

DANGER: Ensure that the power supply is off by unplugging the *Pixel Drive 8* before connecting or disconnecting fixtures.

Stand-alone Operation

Refer to the four buttons on the front panel of the *Pixel Drive 8*:



Press the MODE button to view the Chase menu:



Select Chases 1-9 using the UP and DOWN buttons
Chases 1-8 run according to the Fade and Speed values
Chase 9 is sound-active

Press the F/S button to set the Fade and Speed values:



Adjust Chase Fade Time from 0-100%



Adjust Chase Speed from 1-500 steps per minute

Press the MODE button to view the Manual Color Mixing menu:



Press F/S to begin
Use UP and DOWN buttons to mix RGB values

Sound-active Operation

In Stand-alone mode, select Chase 9 and adjust the audio input level using the sensitivity control dial on the side panel of the *Pixel Drive 8*.

In DMX mode, use Channel 6 to select Sound-active operation and to adjust the audio sensitivity.

DMX Operation

Press the MODE button to view the DMX address setting menu:



Select the DMX starting address for the *Pixel Drive 8* using the UP and DOWN buttons

The DMX Channel functions are:

Channel 1 : Rainbow

Channel 2 : Red (0 - 100%)

Channel 3 : Green (0 - 100%)

Channel 4 : Blue (0 - 100%)

Channel 5 : Strobe (1 - 20 Hz)

Channel 6 : Sound-active / Audio sensitivity

The *Pixel Drive 8* will automatically detect the presence of a DMX signal. If a DMX signal is present, the front panel LED display will blink.

In order to receive a DMX signal, the *Pixel Drive 8* must be attached to a DMX controller by a 3-pin DMX cable and the DMX controller must be turned on.

To mix RGB colors using DMX, Channel 1 (Rainbow) must be off (0).

When programming your own DMX sequences, note that Channel 6 must be off (0) to avoid activating Sound-active mode during playback.

The *Octopod* system can operate as a 48-, 24-, 12- or 6-channel DMX fixture. Select DMX Mode 1, 2, 3 or 4 as described on the facing page.

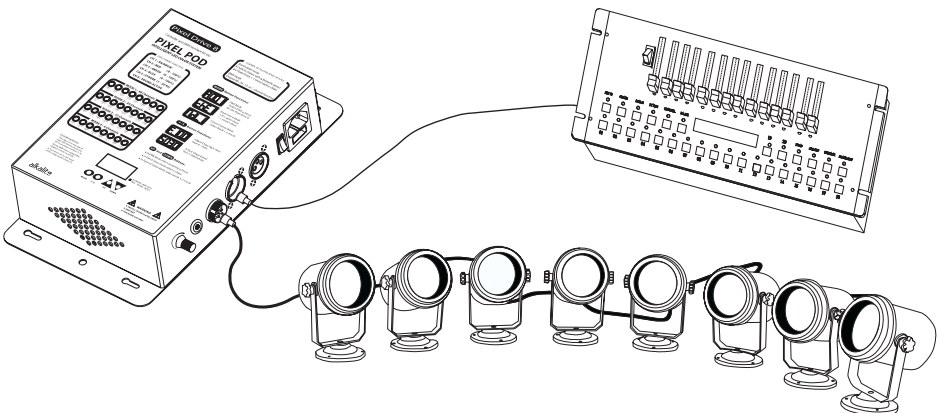

DMX MODES:

Press the MODE button to view the DMX mode selection menu.
Use the UP and DOWN buttons to select the DMX mode.



DMX Mode 1 : 48-channel operation
(Control each *Octopod* fixture independently)

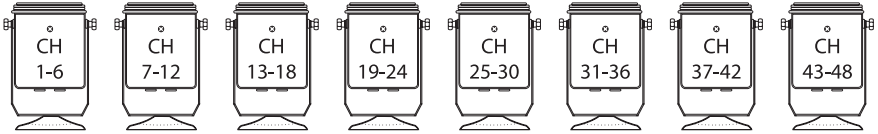

DMX Mode 2 : 24-channel operation
(Control 4 sets of 2 *Octopod* fixtures)



DMX Mode 4 : 12-channel operation
(Control 2 sets of 4 *Octopod* fixtures)

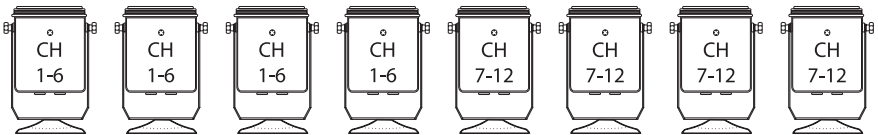

DMX Mode 8 : 6-channel operation
(Control 8 *Octopod* fixtures in unison)

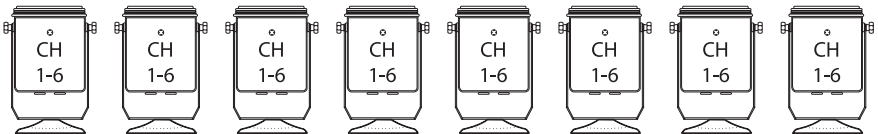

Fuse Replacement

The *Pixel Drive 8* fuse may be replaced as illustrated below.

Disconnect AC mains power before replacing.

Replace with fuse of same type and rating.

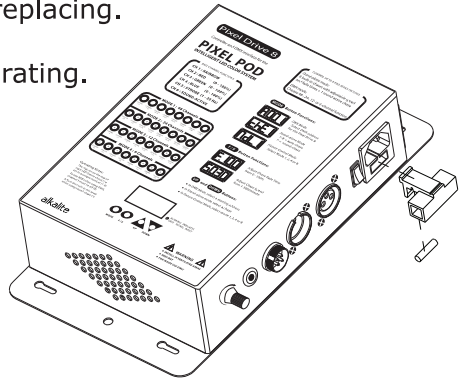

Technical Specifications

PIXEL DRIVE 8 CONTROLLER	
POWER SUPPLY:	240V/50Hz <input type="checkbox"/> 230V/50Hz <input type="checkbox"/> 120V/60Hz <input type="checkbox"/> 110V/60Hz <input type="checkbox"/>
POWER CONSUMPTION:	90W
CONTROL:	DMX, BUILT-IN MIC, AUTO
DIMENSIONS:	305 x 160 x 75mm
WEIGHT:	3.1 KG
FUSE:	250V/.5A / 125V/.15A
OCTOPOD FIXTURE	
POWER SUPPLY:	12V
POWER CONSUMPTION:	10.8W
DIMENSIONS:	115 x 95 x 147mm
WEIGHT:	0.38 KG

Warranty

Alkalite warrants its products to be free of manufacturing defects in material and workmanship for a period of 90 days from the date of original purchase. For products properly registered under Alkalite's warranty registration program (details below), Alkalite warrants its products for a period of 1 year from the original purchase date. This warranty shall be valid only if the product is purchased from Alkalite or its authorized distributors or dealers. It is the purchaser's responsibility to establish the date and place of purchase by acceptable evidence at the time service is sought. For warranty service, send the product only to an authorized Alkalite distributor or dealer.

All warranties are void if the serial number has been altered or removed; if the product has been modified in any manner; if the product has been repaired or serviced by unauthorized personnel; or if the product is damaged due to improper use or maintenance as set forth in the instruction manual.

This is not a service contract and does not include standard maintenance or cleaning. Lamps, fuses, brushes, belts and all expendables are not covered by this warranty.

Alkalite reserves the right to change design and specifications without obligation to include these changes in previously manufactured products.

Additional warranties provided at the discretion of Alkalite distributors or dealers shall remain the sole obligation of the distributor or dealer.

Warranty Registration

To register this product with Alkalite, send a plain text email to warranty@alkalite.com including the following information within 30 days of purchase:

Date Purchased:
Model Number or Model Name:
Serial Number:

Your Name:
Your Location:
Purchased From:

alkalite

info@alkalite.com

© 2003