

PRODUCTION PRINT

High End Systems

10/24/2006

Issued By: Lee Fredrickson

24 23 22 21 20 19 18 17 16 15 14 13 12 11 10 9 8 7 6 5 4 3 2 1

SYA073

REV.	DESCRIPTION	DATE	ENG	ECO #	APPR
-	RELEASE	05SEP01	KDB	#818	
A	IMPORT BOM FROM SYTELIN: MOVE ISO VIEW TO SHEET 2 REPLACE MOTORS W/SMCO MOTORS: 99270031 NOW 99270062 --02V	08APR03	LR	#1204	DF
B	WAS: SMCO MOON MTR (99270062), NOW 99270070 NMB	23JAN04	LR	#1429	KC
C	CHG FROM BEARING TO GARLOCK LINEAR SHAFTS WAS 80071280, NOW 80071472 PLATE WAS 99260236, NOW 99260295 COLLAR WAS 99260233, NOW 99260278 SHAFT WAS 90701162, NOW 90701184 CLIP ADD SYA072 (GARLOCK BRG ASSY) AS SEPARATE ITEMS	21OCT04	LR	#1494	DF
D	REPLACE INDIVIDUAL ITEMS OF LINEAR BRG WITH 80570015 SUB-ASSY	21JUN05	LR	#1735	DF
E	ITEM CHANGED (MR109) ADVANCE REV ON BOM	05OCT05	LR	#1800	DF
F	ITEM CHANGED (HARNESS) ADVANCE REV ON BOM	12OCT05	LR	#1818	DP
G	CHANGED 80040019 TO 80040019EF	20OCT06	KLB	#2099	KDB

41	1	SYA032	80190043	-	WHEEL,EFFECTS FIBROID STC250
40	1	SYA029	80190044	-	WHEEL,COLOR YELLOW STC250
39	1	SYA030	80190045	-	WHEEL,COLOR CYAN STC250
38	1	SYA031	80190051	A	WHEEL, COLOR WASH REVERSE MAGENTA STC250
37	1	TUBING190X312X500LG	90717029	-	TUBING, SILICONE RED 3/16 I.D 5/16 O.D
36	4	TIE_WRAP3-4	99330007	-	TIE WRAP 3in, 4in, 105C BLK
35	1	SY337	85000187	-	STOP, HOMING DRIVE SCREW (SC-250)
34	8	SY313	90702126	-	STANDOFF, HEX OPTICAL MODULE SC 250
33	3	SPACER250RND375	90702118	-	SPACER, 5/16 ROUND #4 X 3/8 AL
32	2	SW316	99260278	A	SHAFT, 8MM DIA X 4.25
31	1	SP410	90721006	-	SCREW, FOCUS DRIVE, .280 SHANK
30	2	SCREW8-18PPB250BZ	90709024	I	SCREW, PHIL PAN #8 X 1/4 TYPE B SBZ
29	3	SCREW8-32AC187X187BZ	90708014	.	SCREW, 8-32 SOCKET SHOULDER 3/16 X 3/16
28	2	SCREW8-32PPW313BZ	90709136	.	SCREW, 8-32 PHIL PAN 5/16 BZ W/STAR WSHR
27	3	SCREW8-32PFU380S	90709141	.	SCREW, 8-32 PHIL FLAT UC 3/8 BZ PATCH
26	4	SCREW6-32AC250BZP	90707045	.	SCREW, 6-32 SOCKET CAP 1/4 BZ PATCH
25	4	SCREW4-40PFU250T	90711023	.	SCREW, 4-40 PHIL FLAT UC 1/4 TAPTITE SBZ
24	10	SCREW4-40PFU250P	90711044	I	SCREW, 4-40 PHIL FLAT UC 1/4 PATCH
23	3	SCREW4-40PF625SBZ	90709134	.	SCREW, 4-40 PHIL FLAT 5/8
22	2	SCREW4-20PTB250BZ	90709114	.	SCREW, 4-20 X .25 PHIL LOW TRUSS PLASTITE
21	16	SCREW8-18TPB380BZ	90709036	.	SCREW, #8 PHIL TRUSS 3/8 B TYPE SS B/O
20	8	SCREW4-20PP250SZ	90709129	.	SCREW, #4 PHIL PAN 1/4 SZ
19	3	RIVET42FAO	90701136	.	RIVET, 42 FAO COUNTERSINK OPEN
18	1	RING_312EXS	90701184	-	RING, RETAINING, GROOVELESS 5/16
17	1	SY137	80071281	H	PLATE, MID, ST2
16	1	SY186	80071472	C	PLATE, FRONT GARLOCK BEARING ST2
15	2	SY174	80071338	D	PARTITION, HOT MIRROR COATED S 250
14	1	SYA072	80570015	B	MOUNT, LINEAR GARLOCK BEARING ASSY ST2 SVC
13	6	MR109_02	99270070	B	MOTOR, STEP 2PH S17 02V ALNICO NMB
12	1	SYA067	80370007	-	HUB, DIM WHEEL ASSY STUDIO COLOR 250
11	1	SY439	90409051	-	HARNESS, FRONT HEAD MOTOR, SC 250
10	1	SY161	99110048	A	HALF-WHEEL, DIM SC 250
9	1	SY162	99430028	-	GEAR, 36 TOOTH STAMPED
8	1	SP441	99430041	-	GEAR ASSY, 45 TOOTH, W/HUB & DOMED RIVETS SP
7	1	SW435	90701157	A	GASKET SHAFT SUPPORT
6	1	TB371	90701137	B	COUPLER, BONDED RUBBER 50 DUR EPDM BLACK
5	2	SW307	99260295	A	COLLAR, SHAFT MOUNTING
4	2	CLAMP_380HALF_NY	90410071	.	CLAMP, HALF 3/8 NYLON BLK, .203 MNT
3	1	SY122	99260219	A	BRACKET, SENSOR STUDIO COLOR 250
2	4	TB090	80040019EF	I	BOARD, SENSOR ASSY TECHNOBEAM
1	1	SYA021	80580025	-	ASSY, HOT MIRROR STC250/STS250
ITEM NO.	QTY.	FILENAME	PART NO.	REV.	DESCRIPTION

BILL OF MATERIALS

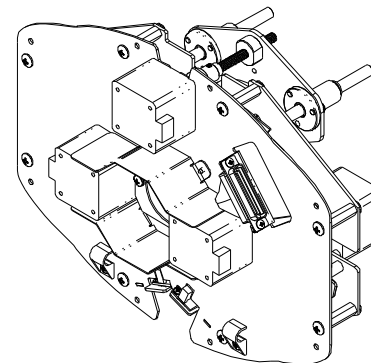
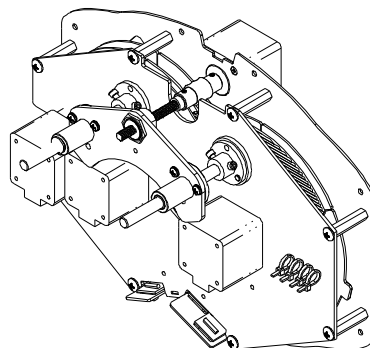

UNLESS OTHERWISE SPECIFIED	RELEASE DATE: 15JUL98	CE:	High End	2105 GRACY FARMS LANE AUSTIN, TEXAS 78758 (512) 836-2242 FAX (512) 832-4128 http://www.highend.com	LR LIGHTWAVE RESEARCH
DIMENSIONAL TOLERANCES:	ENG: KEITH D. BICKERS	QA:			
0 PLACE DECIMAL = ±0.38	ME:				
1 PLACE DECIMAL = ±0.25	MF:	DRW: K. BICKERS			
2 PLACE DECIMALS = ±0.13	DESCRIPTION:				
ANGLES = ±0.5°	OPTICAL MOD, ASSY GARLOCK BEARING ST2 SVC				
FOR PAINTED PARTS REFER TO ENG. SPEC. MANUAL W1-0592	MATERIAL:	FINISH:			
MIN. DRAFT	CHARTED	NA			
MIN. RADII	INTERPRET DIMENSIONS PER ASME Y14.5M-1994	PART NO:	80570013	DRAWING NO:	SYA073
FLATNESS	THIRD ANGLE PROJECTION	REV:	G		
THICKNESS	DIMENSIONS ARE IN MILLIMETERS	DO NOT SCALE	SCALE: 0.630	SHEET: 1 OF 2	
VOLUME					

PROPRIETARY NOTICE:

THIS DOCUMENT CONTAINS CONFIDENTIAL AND PROPRIETARY INFORMATION OF HIGH END SYSTEMS INC., (ALSO DBA LIGHTWAVE RESEARCH) AND IS GIVEN TO THE RECEIVER IN CONFIDENCE. THE RECEIVER ACCEPTS AND AGREES THAT, EXCEPT AS AUTHORIZED BY HIGH END SYSTEMS, THE RECEIVER WILL NOT PERMIT THE USE OF THE DOCUMENT OR ANY COPY THEREOF OR THE INFORMATION THEREIN, WILL NOT COPY OR PERMIT COPYING THE DOCUMENT OR THE INFORMATION THEREIN, AND WILL UPON COMPLETION OF THE NEED TO RETAIN THE DOCUMENT, OR UPON DEMAND, RETURN THE DOCUMENT WITHOUT RETAINING ANY OF THE INFORMATION CONTAINED THEREIN IN ANY FORM WHATSOEVER.

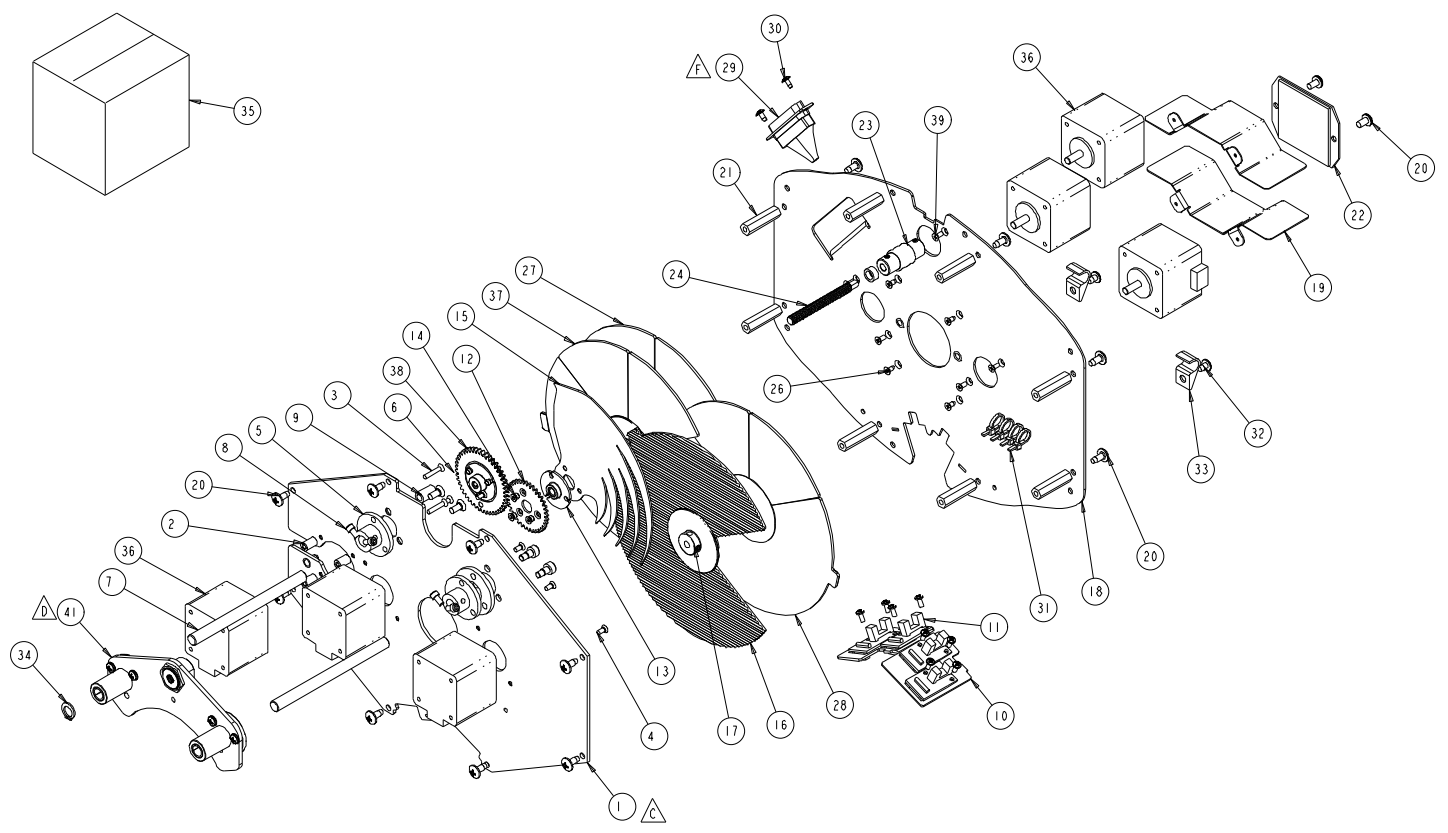

PROPRIETARY NOTICE:

THIS DOCUMENT CONTAINS CONFIDENTIAL AND PROPRIETARY INFORMATION OF HIGH END SYSTEMS INC., ALSO DBA LIGHTWAVE RESEARCH AND IS GIVEN TO THE RECEIVER IN CONFIDENCE. THE RECEIVER ACCEPTS AND AGREES THAT, EXCEPT AS AUTHORIZED BY HIGH END SYSTEMS, THE RECEIVER WILL NOT PERMIT THE USE OF THE DOCUMENT OR ANY COPY THEREOF OR THE INFORMATION THEREIN, WILL NOT COPY OR PERMIT COPYING THE DOCUMENT WILL NOT DISCLOSE TO OTHERS EITHER THE DOCUMENT OR THE INFORMATION THEREIN, AND WILL UPON COMPLETION OF THE NEED TO RETAIN THE DOCUMENT, OR UPON DEMAND, RETURN THE DOCUMENT WITHOUT RETAINING ANY OF THE INFORMATION CONTAINED THEREIN IN ANY FORM WHATSOEVER.

UNLESS OTHERWISE SPECIFIED		RELEASE DATE: 15JUL98	CE: _____	2105 GRACY FARMS LANE AUSTIN, TEXAS 78758 (512) 836-2242 FAX (512) 832-4128 ***** http://www.highend.com	LIGHTWAVE RESEARCH
DIMENSIONAL TOLERANCES: 0 PLACE DECIMAL = ±0.38 1 PLACE DECIMAL = ±0.25 2 PLACE DECIMALS = ±0.13 ANGLES = ±0.5°		ENG: KEITH D. BICKERS	QA: _____		
FOR PAINTED PARTS REFER TO ENG. SPEC. MANUAL WI-0592		MFG: _____	DRW: K. BICKERS		
MIN. DRAFT		DESCRIPTION: OPTICAL MOD, ASSY GARLOCK BEARING ST2 SVC		FINISH: NA	
MIN. RADI		MATERIAL: CHARTED			
FLATNESS		INTERPRET DIMENSIONS PER ASME Y14.5M-1994		PART NO: 80570013	
THICKNESS		THIRD ANGLE PROJECTION		DRAWING NO: SYA073	
VOLUME		DIMENSIONS ARE IN MILLIMETERS		REV: G	
		SI METRIC A1		DO NOT SCALE	
		SCALE: 0.625		SHEET: 2 OF 2	