

FOR SERVICE
REFERENCE ONLY

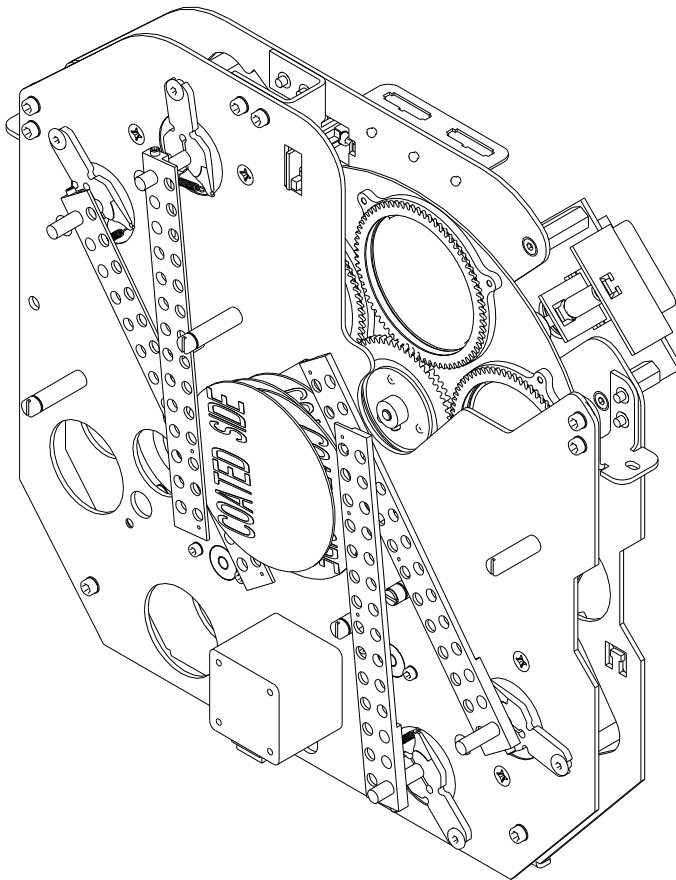

19	AR	GREASE, KRYTOX	99250004	GREASE, KRYTOX
18	1	TWA092	80560047	WHEEL, ASSY, W/LITHO & MOTORS SG SVC
17	4	TW368	90702370	STANDOFF, M4, F/F, L=1.115
16	2	TW369	80070478	STANDOFF, M4, F/F, L=1.000
15	16	SCREW M4 AF08BZ	91040408	SCREW, M4 SOCKET CSNK FLAT 08 BZ W/PATCH
14	2	SCREW M4 AC25W-BZ	91000425	SCREW, M4 SOCKET CAP 25 BZ SEMS
13	8	SCREW M4 AC08BZ	91000408	SCREW, M4 SOCKET CAP 08 BZ SEMS
12	2	SCREW M3 AF06BZP	91040306	SCREW, M3 SOCKET CSNK FLAT 06 BZ W/PATCH
11	6	SCREW M3 AC06W-BZ	91000306	SCREW, M3 SOCKET CAP 06 BZ SEMS
10	2	TW665	99263121	MOUNT, SUPPORT, IRIS BULKHEAD
9	1	TW662	99263120	MOUNT, SENSOR PCB, ROT GOBO
8	1	MRI08_01	99270075	MOTOR, STEP 2PH MET S17 11.5mm ALNICO NMB
7	1	TWA076	80430101	MODULE, ASSY, COLOR, YELLOW/CYAN, SG SVC
6	1	TWA079	80160065	LENS, ASSY, ACHROMAT SG SVC
5	1	_ME80_SAHM_DRIVERING	99290033	IRIS, HI TEMP, 75MM ID, 1.8 LEAF, GEARDR 1A
4	1	FS058	99430067	GEAR, ASSY DRIVE 52 TOOTH OVERMOLD
3	1	TW659	80070471	BULKHEAD, IRIS
2	1	CT413	80040021EF	BOARD, SENSOR MINIATURE ASSY COLOR PRO HX
1	1	BLOWER_DELTA_BFB0524HH	80270041EF	BLOWER ASSY, 24 V 51mm, GOBO
ITEM NO.	QTY.	FILENAME	PART NO.	DESCRIPTION

BILL OF MATERIALS

UNLESS OTHERWISE SPECIFIED:	RELEASE DATE:	CE:	High End	2105 GRACY FARMS LANE AUSTIN, TEXAS 78758 (512) 836-2242 FAX (512) 832-4128 ***** http://www.highend.com	
DIMENSIONAL TOLERANCES:	ENG:	OA:			
0 PLACE DECIMAL = ±0.38	ME:	DRW:			
1 PLACE DECIMAL = ±0.25	MEG:				
2 PLACE DECIMALS = ±0.13					
ANGLES = ±0.5°	DESCRIPTION:				
FOR PAINTED PARTS REFER TO ENG. SPEC. MANUAL WI-0582	BULKHEAD, ASSY, IRIS SG SVC				
ALL COMPONENTS, MATERIALS AND FINISHES TO BE R&HS COMPLIANT	MATERIAL:				
	CHARTED				
MIN. DRAFT	INTERPRET DIMENSIONS PER ASME Y14.5M-1994	SI METRIC	PART NO.	DRAWING NO.	REV.
MIN. RADI1	THIRD ANGLE PROJECTION	A1	80430102	TWA077_SVC	NA
FLATNESS	DIMENSIONS ARE IN MILLIMETERS		DO NOT SCALE	SCALE: 0.333	SHEET: 1 OF 3
THICKNESS					
VOLUME					

PROPRIETARY NOTICE:
THIS DOCUMENT CONTAINS CONFIDENTIAL AND PROPRIETARY INFORMATION OF HIGH END SYSTEMS INC., (ALSO DBA LIGHTWAVE RESEARCH) AND IS GIVEN TO THE RECEIVER IN CONFIDENCE. THE RECEIVER ACCEPTS AND AGREES THAT, EXCEPT AS AUTHORIZED BY HIGH END SYSTEMS, THE RECEIVER WILL NOT PERMIT THE USE OF THE DOCUMENT OR ANY COPY THEREOF OR THE INFORMATION THEREIN, WILL NOT COPY OR PERMIT COPYING THE DOCUMENT OR THE INFORMATION THEREIN, AND WILL UPON COMPLETION OF THE NEED TO RETURN THE DOCUMENT, OR UPON DEMAND, RETURN THE DOCUMENT WITHOUT RETAINING ANY OF THE INFORMATION CONTAINED THEREIN IN ANY FORM WHATSOEVER.

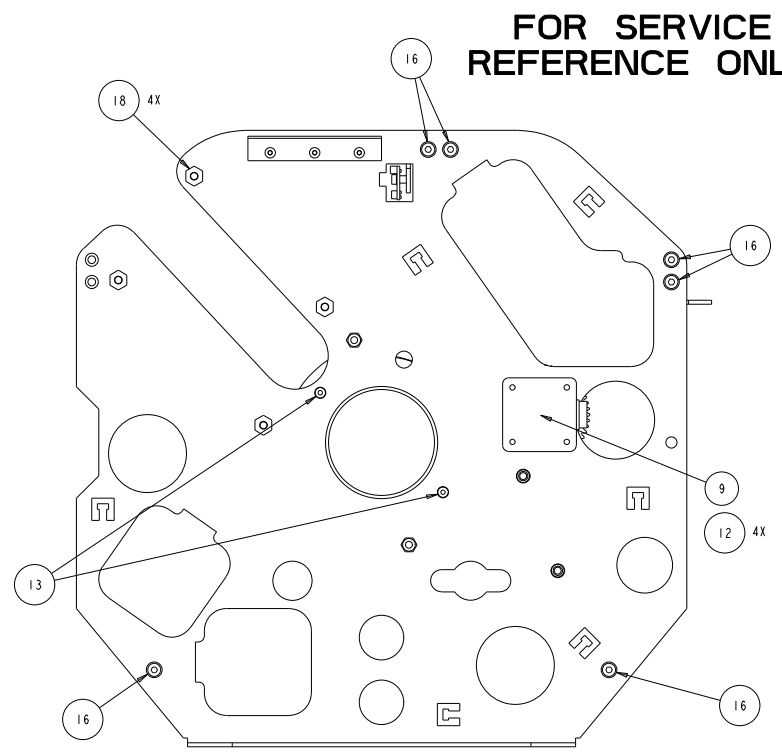
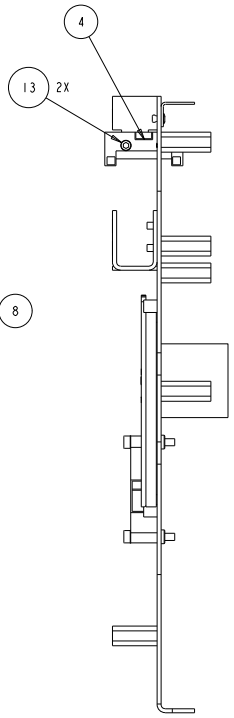
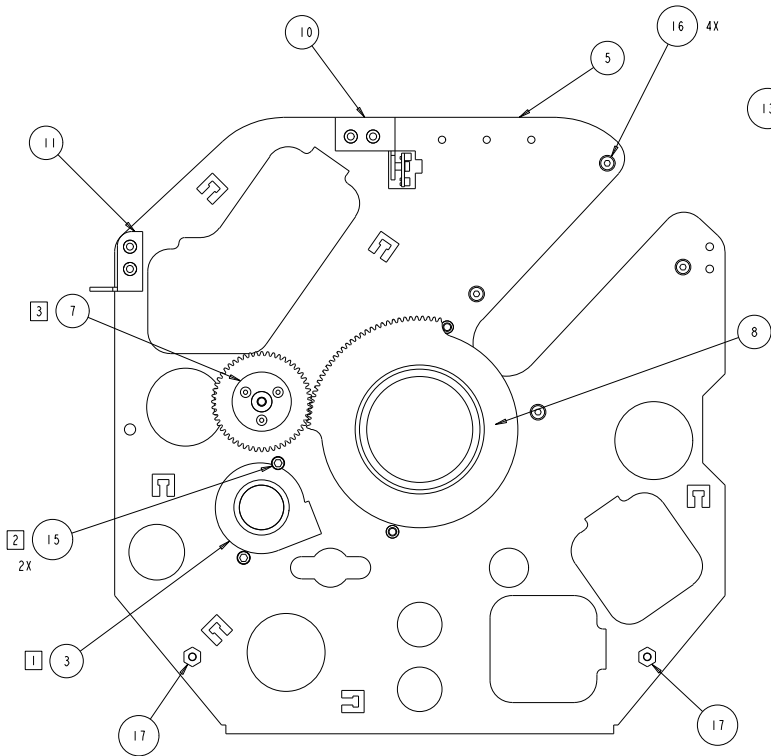

**FOR SERVICE
REFERENCE ONLY**

NOTES: APPLICABLE TO VIEWS ON THIS SHEET ONLY

- 1. VERIFY WIRING ON BLOWER MOUNT FACE IS ENGAGED UNDER WIRE RETENTION TAB.
- 2. MAX TORQUE ON MOUNT SCREWS 6 IN POUNDS.
- 3. SET TOP FACE OF OVERMOLDED GEAR ASSEMBLY FLUSH WITH TOP FACE OF IRIS GEAR.

COLOR ASSEMBLY TWA076, GOBO ASSEMBLY TWA092, AND LENS ASSEMBLY TWA079 DELETED THIS PAGE FOR CLARITY

PROPRIETARY NOTICE:
THIS DOCUMENT CONTAINS CONFIDENTIAL AND PROPRIETARY INFORMATION OF HIGH END SYSTEMS INC., (ALSO DBA LIGHTWAVE RESEARCH) AND IS GIVEN TO THE RECEIVER IN CONFIDENCE. THE RECEIVER ACCEPTS AND AGREES THAT, EXCEPT AS AUTHORIZED BY HIGH END SYSTEMS, THE RECEIVER WILL NOT PERMIT THE USE OF THE DOCUMENT OR ANY COPY THEREOF OR THE INFORMATION THEREIN, WILL NOT COPY OR PERMIT COPYING THE DOCUMENT, WILL NOT DISCLOSE TO OTHERS EITHER THE DOCUMENT OR THE INFORMATION THEREIN, AND WILL UPON COMPLETION OF THE NEED TO RETAIN THE DOCUMENT, OR UPON DEMAND, RETURN THE DOCUMENT WITHOUT RETAINING ANY OF THE INFORMATION CONTAINED THEREIN IN ANY FORM WHATSOEVER.

UNLESS OTHERWISE SPECIFIED		RELEASE DATE:	CE:	2105 GRACY FARMS LANE AUSTIN, TEXAS 78758 (512) 836-2242 FAX (512) 832-4128 ***** http://www.highend.com	LIGHTWAVE RESEARCH
DIMENSIONAL TOLERANCES:		ENG:	OA:		
0 PLACE DECIMAL = ±0.38		ME:	DRW:		
1 PLACE DECIMAL = ±0.25					
2 PLACE DECIMALS = ±0.13				DESCRIPTION: BULKHEAD, ASSY, IRIS SG SVC	
ANGLES = ±0.5°				MATERIAL: CHARTED	
FOR PAINTED PARTS REFER TO ENG. SPEC. MANUAL WI-0592				FINISH: N/A	
ALL COMPONENTS, MATERIALS AND FINISHES TO BE RHHS COMPLIANT				PART NO. 80430102	
MIN. DRAFT		INTERPRET DIMENSIONS PER ASME Y14.5M-1994		DRAWING NO. TWA077_SVC	
MIN. RADI		THIRD ANGLE PROJECTION		REV. NA	
FLATNESS		DIMENSIONS ARE IN MILLIMETERS		DO NOT SCALE	
THICKNESS				SCALE: 0.333	
VOLUME				SHEET: 2 OF 3	

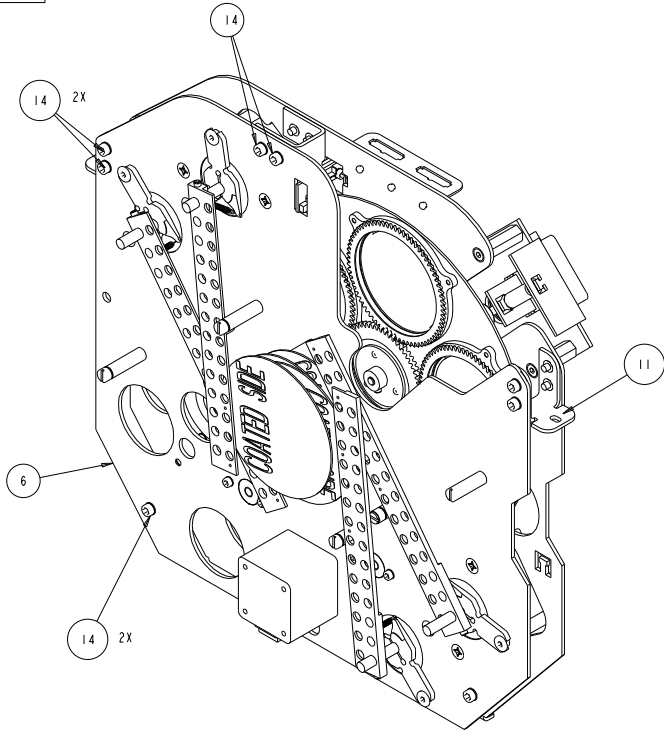

SCALE 0.750

NOTES: APPLICABLE TO VIEWS ON THIS SHEET ONLY

- 1. TIGHTEN SCREWS AFTER ACHROMAT LENS ASSEMBLY IS INSTALLED ONTO SHAFTS AND DRIVE NUT IS ENGAGED FULL TRAVEL AGAINST HOMING STOP.
- 2. APPLY KRYTOX LUBRICANT TO DRIVE SCREW.

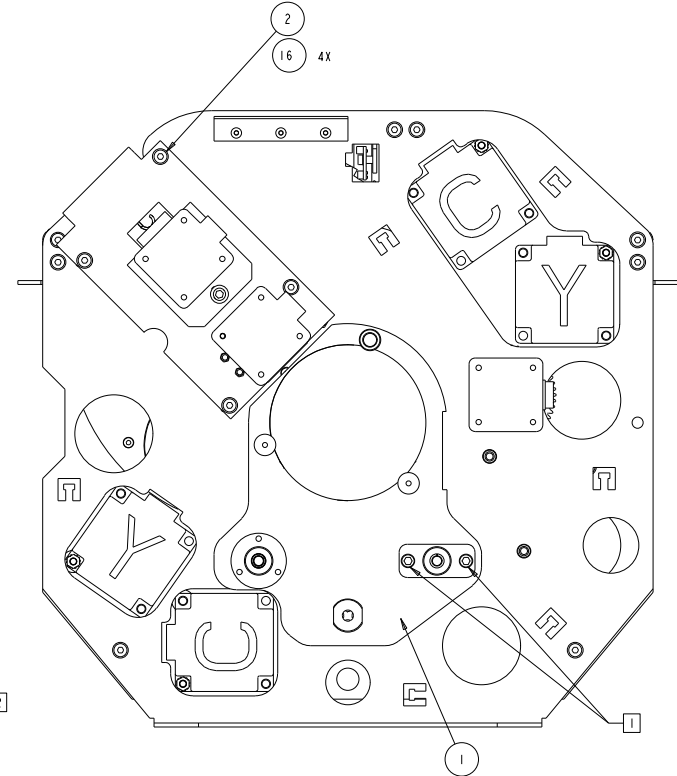
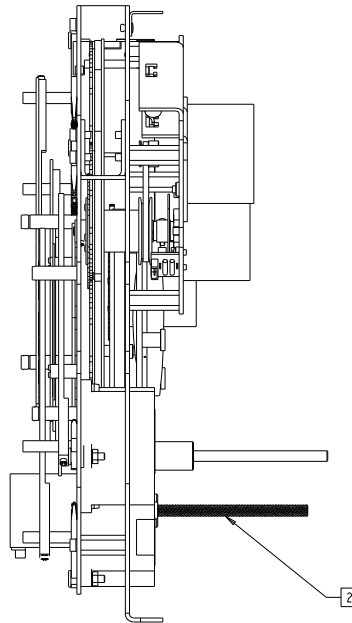

**FOR SERVICE
REFERENCE ONLY**

PROPRIETARY NOTICE:
THIS DOCUMENT CONTAINS CONFIDENTIAL AND PROPRIETARY INFORMATION OF HIGH END SYSTEMS INC., (ALSO DBA LIGHTWAVE RESEARCH) AND IS GIVEN TO THE RECEIVER IN CONFIDENCE. THE RECEIVER ACCEPTS AND AGREES THAT, EXCEPT AS AUTHORIZED BY HIGH END SYSTEMS, THE RECEIVER WILL NOT PERMIT THE USE OF THE DOCUMENT OR ANY COPY THEREOF OR THE INFORMATION THEREIN, WILL NOT COPY OR PERMIT COPYING THE DOCUMENT OR DISCLOSE TO OTHERS EITHER THE DOCUMENT OR THE INFORMATION THEREIN, AND WILL UPON COMPLETION OF THE NEED TO RETAIN THE DOCUMENT, OR UPON DEMAND, RETURN THE DOCUMENT WITHOUT RETAINING ANY OF THE INFORMATION CONTAINED THEREIN IN ANY FORM WHATSOEVER.

UNLESS OTHERWISE SPECIFIED		RELEASE DATE:	CE:	2105 GRACY FARMS LANE AUSTIN, TEXAS 78758 (512) 836-2242 FAX (512) 832-4128 ***** http://www.highend.com	LIGHTWAVE RESEARCH
DIMENSIONAL TOLERANCES:		ENG:	OA:		
0 PLACE DECIMAL = ±0.38		ME:	DRW:		
1 PLACE DECIMAL = ±0.25		MEG:			
2 PLACE DECIMALS = ±0.13		ANGLES = ±0.5°		DESCRIPTION: BULKHEAD, ASSY, IRIS SG SVC	
FOR PAINTED PARTS REFER TO ENG. SPEC. MANUAL WI-0582		MATERIAL:		FINISH:	
ALL COMPONENTS, MATERIALS AND FINISHES TO BE RHHS COMPLIANT		CHARTED		N/A	
MIN. DRAFT	INTERPRET DIMENSIONS PER ASME Y14.5M-1994	SI METRIC A1		PART NO. 80430102	DRAWING NO. TWA077_SVC
MIN. RADI	THIRD ANGLE PROJECTION	DO NOT SCALE		SCALE: 0.333	SHEET: 3 OF 3
FLATNESS	DIMENSIONS ARE IN MILLIMETERS				
THICKNESS					
VOLUME					