

CLA015

REV.	DESCRIPTION	DATE	ENG	ECO #	APPR
1	CREATE DRAWING	01JUL09	PP		
2	UPDATE VIEW	13JUL09	PP		
3	ADD MISSING HARDWARE	17JUL09	PP		
4	REMOVE SL899, ADD CLA041	27JUL09	PP		
5	REN CHANGE TO ITEM 21	16SEP09	PP		
6	REMOVE 2X 91000306, ADD 2X 90707004	06OCT09	PP		
7	REMOVE 2X 90707004 , ADD 2X 91000306	19OCT09	PP		

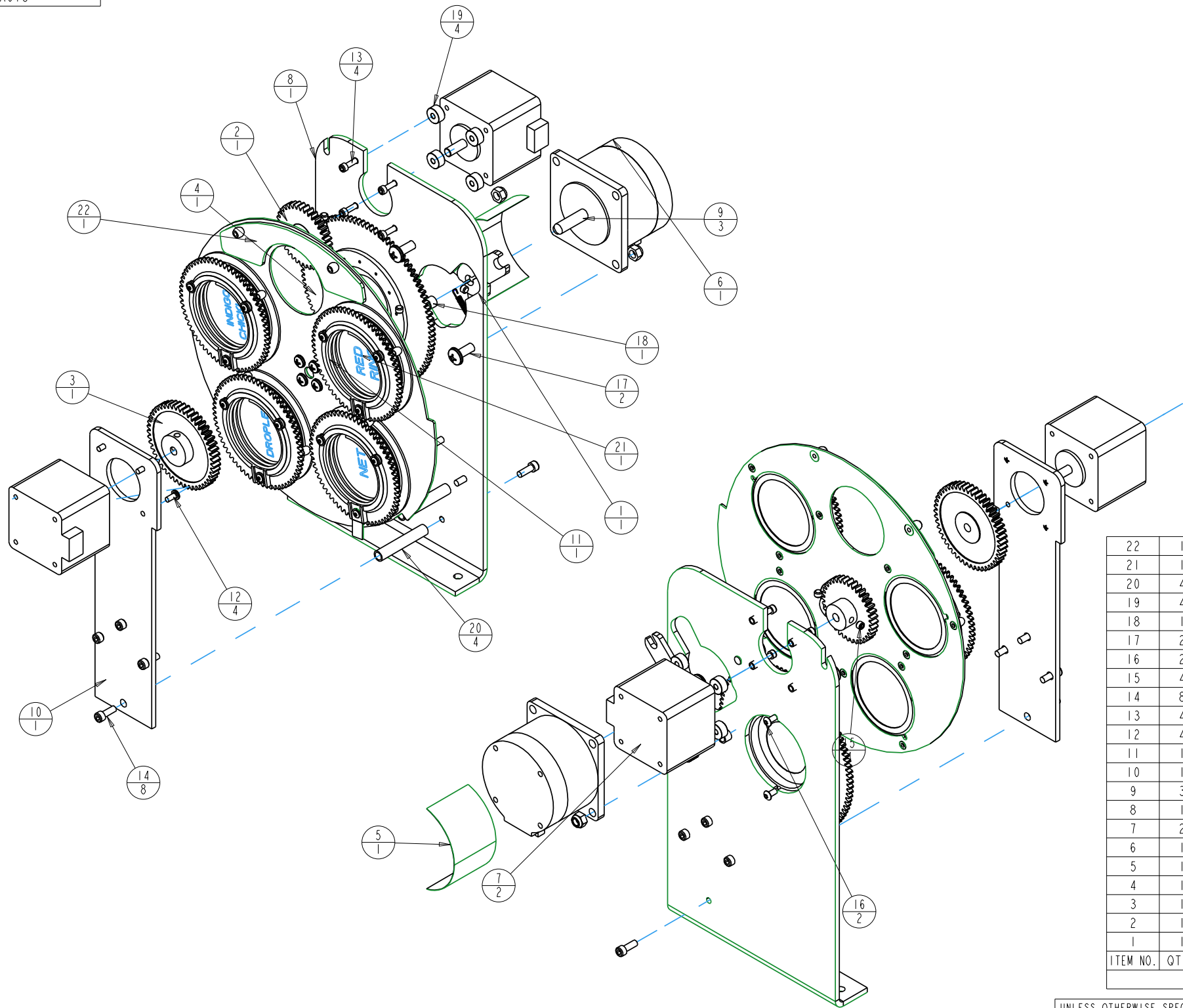

ITEM NO.	QTY.	FILENAME	PART NO.	REV	DESCRIPTION
22	1	CLA041	80190093	-	WHEEL,ASM,ROTATING W/GLS CYB2
21	1	WASHER10-204X440SS	90706012	.	WASHER,FLAT #10 SS
20	4	STANDOFF_6-32_25RND_14375L	90702194	I	STANDOFF,6-32 1/4RND X 1 7/16L F/F AL
19	4	SPACER_375RND_1875LG	90702035	I	SPACER,3/8RND X 3/16LG #4 THRU AL
18	1	SPACER250RND188	90702135	.	SPACER, .188 x 3/16 ID, 1/4 OD
17	2	SCREW10-32PP580W-SS	90709153	.	SCREW,PHIL PAN 10-32X5/8 W/WASHER BZ
16	2	SCREWM3AB06BZP	91010306	.	SCREW,M3 BUTTON SOCKET HD 06 BZ W/PATCH
15	4	SCREW8-32AS125BZ	90707090	.	SCREW,8-32 SOCKET SET 1/8 BZ FLAT PT
14	8	SCREW6-32AC380BZP	90707043	.	SCREW,6-32 SOCKET CAP 3/8 BZ PATCH
13	4	SCREW4-40AC500P	90707006	.	SCREW,4-40 SOCKET CAP 1/2 BZ PATCH
12	4	SCREW4-40PP250SBZP	90709073	.	SCREW,4-40 PHIL PAN 1/4 M/S BZ PATCH
11	1	SCREW10-32PP750BZ	90709097	.	SCREW,10-32 PHIL PAN 3/4 MS BZ
10	1	SL007	80070206	C	PLATE, MOTOR, GOBO, CYBERLIGHT
9	3	NUT10-32LOCK	90703011	.	NUT, LOCK 10-32 NYLON INSERT SZ
8	1	SL141	80071577	C	MOUNT, IRIS LITHO MOTOR BRAKE CL
7	2	MR109_02	99270070	B	MOTOR, STEP 2PH S17 02V ALNICO NMB
6	1	MR004_1	99270020	.	MOTOR, STEP 2P S23 09V SHAFT NMB
5	1	CL461_FORMED	99310545	-	LABEL, MOTOR, ROTATING GOBO
4	1	IRIS_CYBERLIGHT	99290005	I	IRIS, CYBER
3	1	SC201	99290023	-	GEAR, PINION, ALUMINUM HUB CL/CX
2	1	SL310	99290007	C	GEAR, IRIS W/HUB, CL
1	1	SLA012	80140033	-	DAMPER, ASSY, MTR BRAKE .250 SHAFT, CL

UNLESS OTHERWISE SPECIFIED DIMENSIONAL TOLERANCES: 0 PLACE DECIMAL = ±0.38 1 PLACE DECIMAL = ±0.25 2 PLACE DECIMALS = ±0.13 ANGLES = ±0.5°	RELEASE DATE: ENG: ME: MFG:	CE: QA: DRW:	High End 2105 GRACY FARMS LANE AUSTIN, TEXAS 78758 (512) 836-2242 FAX (512) 832-4128 http://www.highend.com	LR LIGHTWAVE RESEARCH
FOR PAINTED PARTS REFER TO ENG. SPEC. MANUAL W1-0592	DESCRIPTION: WHEEL, ROTATING GOBO		FINISH: NA	
ALL COMPONENTS, MATERIALS AND FINISHES TO BE RoHS COMPLIANT	MATERIAL: CHARTED		DRAWING NO. INTERNAL CLA015	
MIN. DRAFT	INTERPRET DIMENSIONS PER ASME Y14.5M-1994	SI METRIC A1	PART NO. INTERNAL	REV. 7
MIN. RADI	THIRD ANGLE PROJECTION	DO NOT SCALE	SCALE: 0.500	SHEET: 1 OF 1
FLATNESS	DIMENSIONS ARE IN MILLIMETERS			
THICKNESS				
VOLUME				

PROPRIETARY NOTICE:
THIS DOCUMENT CONTAINS CONFIDENTIAL AND PROPRIETARY INFORMATION OF HIGH END SYSTEMS INC., (ALSO DBA LIGHTWAVE RESEARCH) AND IS GIVEN TO THE RECEIVER IN CONFIDENCE. THE RECEIVER ACCEPTS AND AGREES THAT, EXCEPT AS AUTHORIZED BY HIGH END SYSTEMS, THE RECEIVER WILL NOT PERMIT THE USE OF THE DOCUMENT OR ANY COPY THEREOF OR THE INFORMATION THEREIN, WILL NOT COPY OR PERMIT COPYING THE DOCUMENT WILL NOT DISCLOSE TO OTHERS EITHER THE DOCUMENT OR THE INFORMATION THEREIN, AND WILL UPON COMPLETION OF THE NEED TO RETAIN THE DOCUMENT, OR UPON DEMAND, RETURN THE DOCUMENT WITHOUT RETAINING ANY OF THE INFORMATION CONTAINED THEREIN IN ANY FORM WHATSOEVER.